

January 4, 2017 (Agenda)

Local Agency Formation Commission  
105 East Anapamu Street  
Santa Barbara CA 93101

**Confirm Existing Spheres of Influence for the Cachuma Resource Conservation District, Casmalia Community Services District, Cuyama Community Services District, Cuyama Valley Recreation and Park District, Embarcadero Municipal Improvement District, Isla Vista Recreation and Park District, Lompoc Valley Healthcare District, Los Alamos Community Services District, Mission Hills Community Services District, Mosquito and Vector Management District, Montecito Fire Protection District, and the Montecito Water District.**

Dear Members of the Commission

RECOMMENDATION

- 1) Consider Recommendations Regarding Updates of Existing Spheres of Influence, as follows:
  - a) Determine that the action is exempt from CEQA pursuant to CEQA Guidelines section 15061(b)(3), and
  - b) Adopt resolutions, that confirm the existing Spheres of Influence for the following special districts:
    - Cachuma Resource Conservation District
    - Carpinteria Valley Water District
    - Casmalia Community Services District
    - Cuyama Community Services District
    - Cuyama Valley Recreation and Park District
    - Embarcadero Municipal Improvement District
    - Isla Vista Recreation and Park District
    - Lompoc Valley Healthcare District
    - Los Alamos Community Services District
    - Mission Hills Community Services District
    - Mosquito and Vector Management District
    - Montecito Fire Protection District
    - Montecito Water District

## DISCUSSION

### Background:

The law requires that Spheres of Influence be updated every five years. The Santa Barbara Local Agency Formation Commission (LAFCO) received a report from its staff regarding a proposed program and schedule to review and update Spheres of Influence for the cities and special districts in Santa Barbara County.

After receiving the report and discussing the update program, the Commission directed the Executive Officer to confer with local agencies regarding whether changes necessitate new Municipal Service Reviews to update their Spheres of Influence. Updates will be prepared “as necessary” if there are significant changes to the city’s general plan, funding levels, or requested sphere of influence revisions.

### Special District Sphere of Influence Updates

On October 16, 2017, staff sent out Municipal Service Review/Sphere of Influence Update letters to the following special districts:

- Cuyama Resource Conservation District
- Casmalia Community Services District
- Cuyama Community Services District
- Cuyama Valley Recreation and Park District
- Embarcadero Municipal Improvement District
- Isla Vista Recreation and Park District
- Lompoc Valley Medical Center
- Los Alamos Community Services District
- Mission Hills Community Services District
- Mosquito and Vector Management District

In addition, Second Request Update Letters were also sent out to the following three special districts that did not respond to the LAFCO Staff Request Letters in 2016.

- Montecito Fire Protection District
- Montecito Water District
- Carpinteria Valley Water District

The deadline to either request that the Commission reaffirm the exiting spheres of influence, or request changes, was November 17, 2017.

### Current Situation

Within the timeframe, staff received responses from 8 of the 13 special districts requesting that the Commission confirm the exiting spheres of influence. Several districts requested that their Municipal Service Reviews also be updated to reflect the current service situations.

On December 12, 2017, staff followed up on the October 16, 2017 request letters to the 5 the districts that did not respond. Three districts responded almost immediately also requesting that the Commission confirm the exiting spheres of influence. They also that their Municipal Service Review information be updated to reflect the current service situations.

At the time of this staff report the remaining two special districts, the Carpinteria Valley Water District and the Mission Hills Community Services District have not responded to the information requests. For these two districts, staff is recommending that the Commission confirm the exiting spheres of influence. Should the two districts in the future request changed to their SOI/MSR, these request will be considered outside of today's action.

#### EXHIBITS

- Exhibit A Sphere of Influence Requirements
- Exhibit B Cachuma Resource Conservation District
- Exhibit C Carpinteria Valley Water District
- Exhibit D Casmalia Community Services District
- Exhibit E Cuyama Community Services District
- Exhibit F Cuyama Valley Recreation and Park District
- Exhibit G Embarcadero Municipal Improvement District
- Exhibit H Isla Vista Recreation and Park District
- Exhibit I Lompoc Valley Medical Center
- Exhibit J Los Alamos Community Services District
- Exhibit K Mission Hills Community Services
- Exhibit L District Mosquito and Vector Management
- Exhibit M District Montecito Fire Protection District
- Exhibit N Montecito Water District

Please contact LAFCO staff, if you have any questions.

Sincerely,

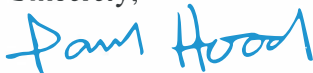

PAUL HOOD  
Executive Officer

A Sphere of Influence is defined in Government Code §56076 as "...a plan for the probable physical boundaries and service area. . ." of a city or special district as adopted by LAFCO.

Government Code §56425 describes the determinations LAFCO must make in adopting spheres and the need for spheres to list types of services currently being provided by special districts.

Government Code §56430 directs LAFCO to prepare Municipal Service Reviews (MSRs) to help inform Commission decisions regarding adopting or updating SOIs.

The Commission has fulfilled its statutory requirement to adopt written MSR determinations and adopt SOIs for cities and special districts within the County.

LAFCO's enabling statute, the Cortese-Knox Local Government Reorganization Act, as revised in 2001 states "On or before January 1, 2008, and every five years thereafter, the commission shall, as necessary, review and update each sphere of influence." (Emphasis added)

The Commission-approved work plan directs the staff to confer with each city and special district to determine whether changes have occurred that would necessitate an in-depth MSR in conjunction with updating the agency's sphere.

If this initial review indicates no changes are needed in the current sphere, the LAFCO staff is to prepare a resolution for the Commission to confirm the existing sphere. If, on the other hand, the initial review indicates circumstances require a more detailed evaluation, the staff is to prepare a new MSR and SOI Update, with appropriate compliance with CEQA.

RESOLUTION OF THE SANTA BARBARA LOCAL AGENCY FORMATION  
COMMISSION MAKING WRITTEN DETERMINATIONS AND CEQA FINDINGS AND  
REAFFIRMING THE SPHERE OF INFLUENCE FOR THE  
CACHUMA RESOURCE CONSERVATION DISTRICT

WHEREAS, a Sphere of Influence is defined as a plan for the probable physical boundaries and service area of a city or special district as adopted by the Commission, and

WHEREAS, the Commission is required to review and update, as necessary, adopted spheres of influence not less than every five years, and

WHEREAS, the Commission is directed to conduct a review of municipal services not later than the time it considers an action to establish or update a sphere of influence, and

WHEREAS, the Commission conducted a municipal service review and adopted a Sphere of Influence for the Cachuma Resource Conservation District on August 3, 2006, and reaffirmed the District's Sphere of Influence on February 3, 2010, and

WHEREAS, in the manner required by law, has given notice of the public hearing by the Commission to review and update the sphere of influence, and

WHEREAS, the Commission has heard, discussed and considered all relevant evidence, including but not limited to, the Executive Officer report, and environmental documents, applicable general and specific, plans and all testimony, correspondence and exhibits received during the public hearing, all of which are included hearing by reference,

NOW THEREFORE, IT IS RESOLVED DETERMINED AND ORDED as follows:

1. The project before the Commission is an update of the sphere of influence the Cachuma Resource Conservation District.
2. The Commission finds this update to be exempt from CEQA because no change of the sphere of influence is being adopted.
3. The sphere of influence is hereby updated and no change is made to the map attached as Exhibit A
4. This resolution was adopted on January 4, 2018 and is effective on the date signed by the Chair.

AYES:

NOES:

ABSTAINS:

Dated: \_\_\_\_\_

\_\_\_\_\_  
Chair  
Santa Barbara Local Agency  
Formation Commission

ATTEST

\_\_\_\_\_  
Jacquelyne Alexander, Clerk  
Santa Barbara Local Agency Formation Commission

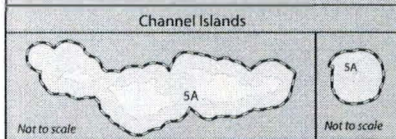
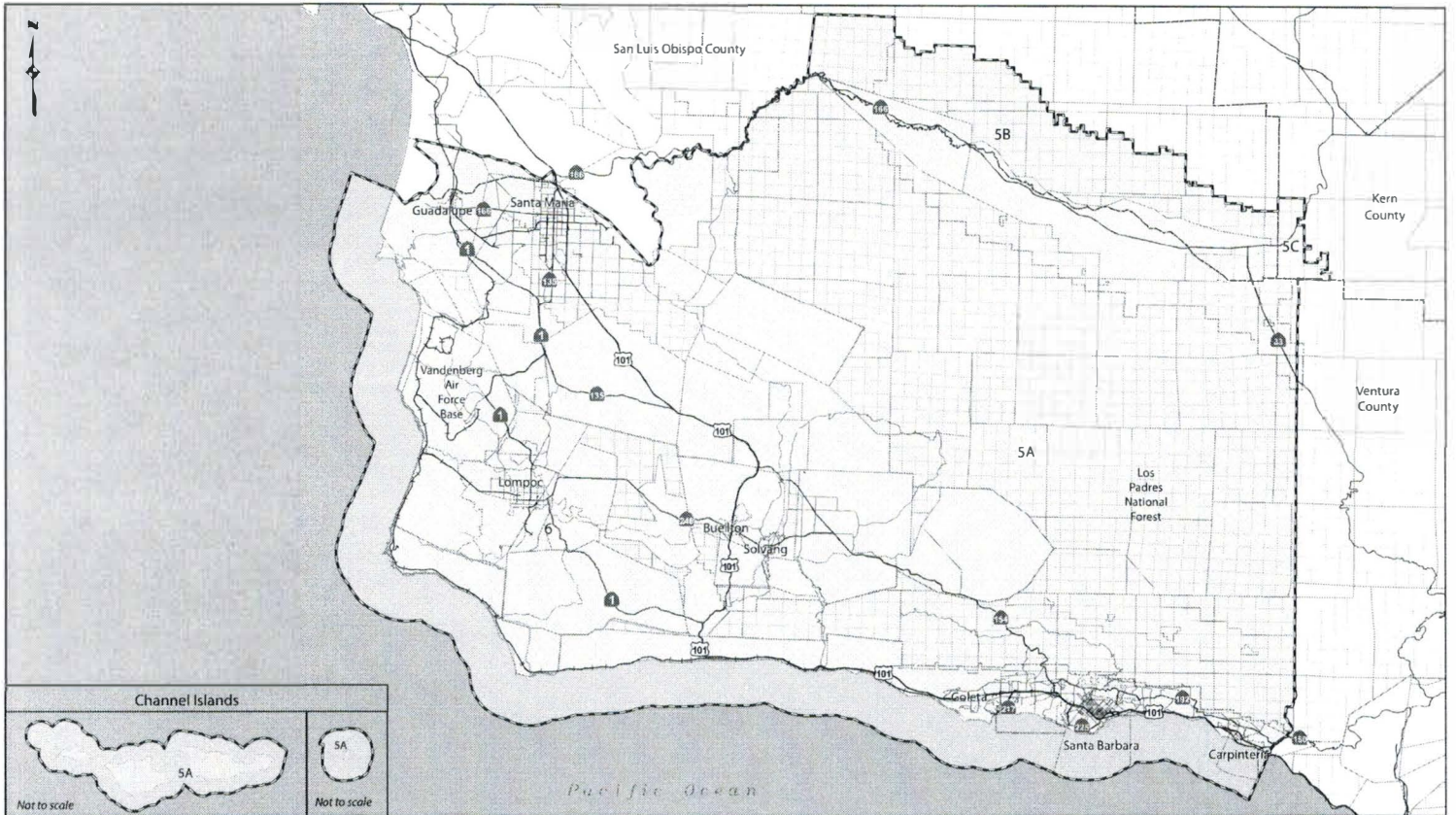

### Cachuma Resource Conservation District

Compiled by the Office of the County Surveyor in August of 2010. Formed as Lompoc Soli Conservation District by BoS Resolution S088 on 5/29/1944. Last Action: Consolidation of Cachuma and Lompoc RCD, LAFCO 96-07, Recorded 8/5/1996 Sphere: 11/4/2010. Boundary activity table at <http://www.countyofsb.org/pwd/pwsurveyor.aspx?id=23260>

NOTICE OF DISCLAIMER: This data is for reference only. Although every effort has been made to ensure the accuracy of information, errors and conditions originating from physical sources used to develop the database may be reflected in this data. Santa Barbara County shall not be held liable for any errors, omissions, or damages that result from the use of the documents. No level of accuracy is claimed for the boundary lines shown hereon and lines should not be used to obtain coordinate values, bearings or distances.



#### Legend

- Freeways
- Highways
- Roads
- Railroads
- Sections
- Cities
- County Boundary
- Vandenberg Air Force Base
- Los Padres National Forest
- Ranchos and Townships
- Sphere of Influence
- Formation
- Annexation
- Detachment

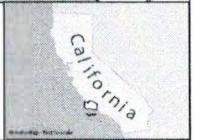

## Cachuma Resource Conservation District Boundary Activity

See map at <http://www.countyofsb.org/pwd/pwsurveyor.aspx?id=23260>

InternalNo	Title	Type	Effective	County Res	County DT	LAFCO No	LAFCO Res	LAFCO Date	Instrument	Recorded
0	Lompoc Soil Conservation District Formation	Formation	5/29/1944	5088	5/29/1944					
1	Southern Coastal Santa Barbara County Soil Cons. Dist.	Formation	12/4/1944	5377	12/4/1944					
2	Santa Maria Valley Soil Conservation District	Formation	6/26/1950	9623	6/26/1950					
3	Cuyama Soil Conservation District	Formation	9/14/1970	70-578	9/14/1970	69-AD-01	196	2/26/1970		
4	Cuyama Soil Cons. to Cuyama Resource Cons. Dist.	Name Change	2/28/1972	72-272	2/28/1972					
4	Santa Maria Valley Soil Cons. to SM Valley Resource Cons. Dist.	Name Change	5/1/1972	72-614	5/1/1972					
4	Lompoc Soil Cons. To Lompoc Resource Cons. Dist.	Name Change	5/30/1972	72-791	5/30/1972					
4	SB Soil Cons. to SB Resource Cons. Dist.	Name Change	6/26/1972	72-880	6/26/1972					
5A	Cachuma Resource Cons. Dist. Consolidation SB, SM, Cuyama - SB Co.	Annexation	12/1/1992			92-R-01	92-836	8/6/1992	1992-0095795	12/1/1992
5B	Cachuma Resource Cons. Dist. Consolidation SB, SM, Cuyama - SLO Co.	Annexation	12/1/1992			92-R-01	92-836	8/6/1992	1992-0095795	12/1/1992
5C	Cachuma Resource Cons. Dist. Consolidation SB, SM, Cuyama - Kern Co.	Annexation	12/1/1992			92-R-01	92-836	8/6/1992	1992-0095795	12/1/1992
6	Consolidation of Cachuma and Lompoc RCD	Annexation	8/5/1996			96-07	96-291	7/16/1996	1996-0047056	8/5/1996
	Cachuma RCD Sphere of Influence	SOI	8/3/2006					8/3/2006		

12/6/2010



RESOLUTION OF THE SANTA BARBARA LOCAL AGENCY FORMATION  
COMMISSION MAKING WRITTEN DETERMINATIONS AND CEQA FINDINGS AND  
REAFFIRMING THE SPHERE OF INFLUENCE FOR THE  
CARPINTERIA VALLEY WATER DISTRICT

WHEREAS, a Sphere of Influence is defined as a plan for the probable physical boundaries and service area of a city or special district as adopted by the Commission, and

WHEREAS, the Commission is required to review and update, as necessary, adopted spheres of influence not less than every five years, and

WHEREAS, the Commission is directed to conduct a review of municipal services not later than the time it considers an action to establish or update a sphere of influence, and

WHEREAS, the Commission conducted a municipal service review and adopted a Sphere of Influence for the Carpinteria Valley Water District on November 3, 2005, and reaffirmed the District's Sphere of Influence on March 1, 2012, and

WHEREAS, in the manner required by law, has given notice of the public hearing by the Commission to review and update the sphere of influence, and

WHEREAS, the Commission has heard, discussed and considered all relevant evidence, including but not limited to, the Executive Officer report, and environmental documents, applicable general and specific, plans and all testimony, correspondence and exhibits received during the public hearing, all of which are included hearing by reference,

NOW THEREFORE, IT IS RESOLVED DETERMINED AND ORDED as follows:

1. The project before the Commission is an update of the sphere of influence the Carpinteria Valley Water District.
2. The Commission finds this update to be exempt from CEQA because no change of the sphere of influence is being adopted.
3. The sphere of influence is hereby updated and no change is made to the map attached as Exhibit A
4. This resolution was adopted on January 4, 2018 and is effective on the date signed by the Chair.

AYES:

NOES:

ABSTAINS:

Dated: \_\_\_\_\_

\_\_\_\_\_  
Chair  
Santa Barbara Local Agency  
Formation Commission

ATTEST

\_\_\_\_\_  
Jacquelyne Alexander, Clerk  
Santa Barbara Local Agency Formation Commission

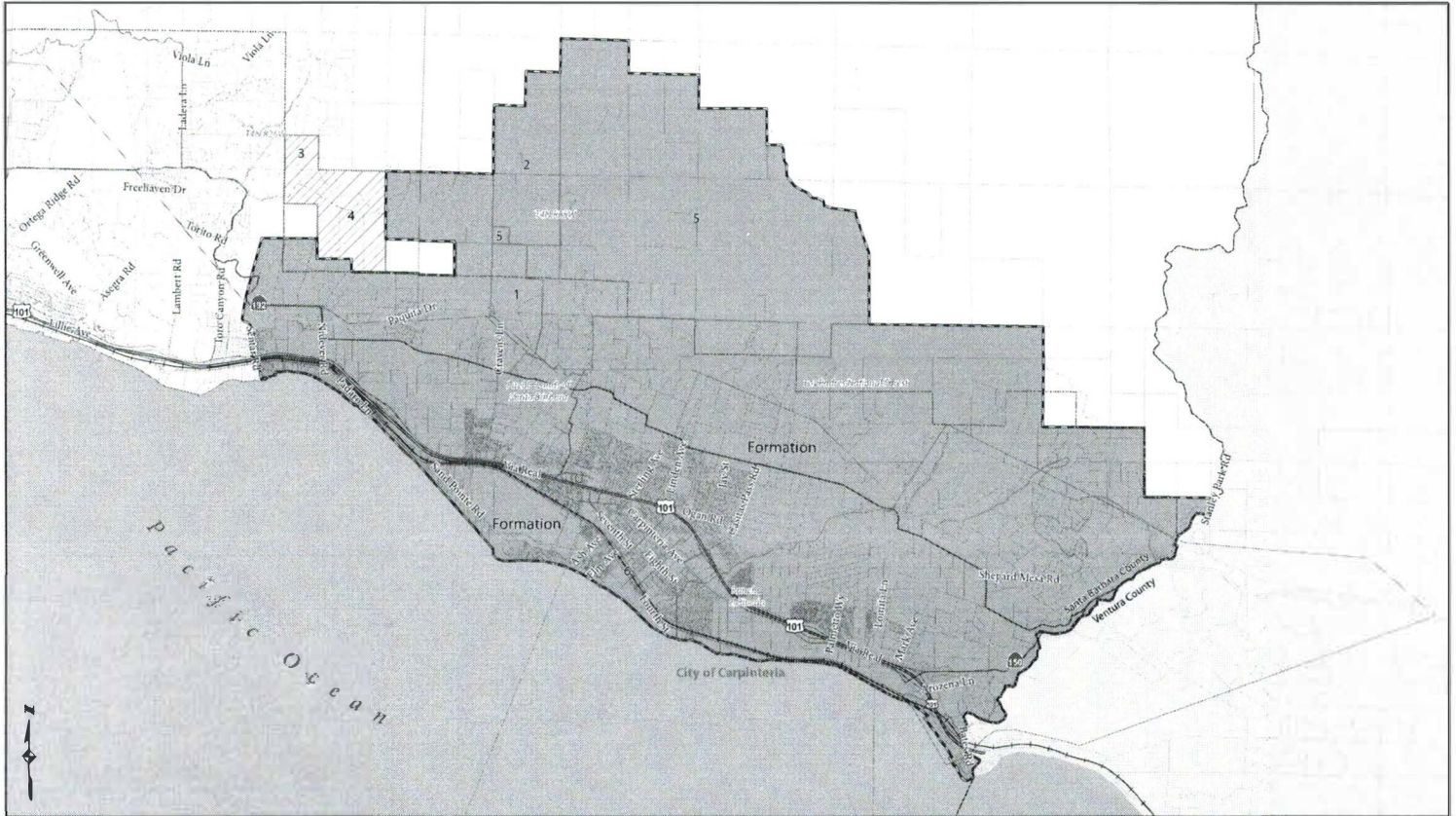

### Carpinteria Valley Water District

Compiled by the Office of the County Surveyor in September of 2014. Formed 2/10/1941.  
 Sphere: 3/1/2012. Last Action: 6. Railroad Corridor Annexation, LAFCO 13-08, 9/10/2014.  
 See Boundary activity table at <http://www.countyofsb.org/pwd/pwsurveyor.aspx?id=23260>

NOTICE OF DISCLAIMER: This data is for reference only. Although every effort has been made to ensure the accuracy of information, errors and omissions originating from physical sources used to develop the database may be reflected in this data. Santa Barbara County shall not be liable for any error, omission, or omissions that result from inappropriate use of this document. No level of accuracy is claimed for the boundary lines shown hereon and lines should not be used to obtain coordinate values, bearings or distances.

GRAPHIC SCALE



#### Legend

- Freeways
- Highways
- Roads
- Railroads
- Parcels
- Sections
- Ranchos and Townships
- Los Padres National Forest
- City Boundaries
- County Boundary
- Ventura County Parcels
- ▭ Sphere of Influence
- ▭ Formation
- ▭ Annexation
- ▭ Detachment



## Carpinteria Valley Water District Boundary Activity

See map at <http://www.countyofsb.org/pwd/pwsurveyor.aspx?id=23260>

InternalNo	Title	Type	Effective	County_Res	County_DT	LAFCO_Res	Instrument	Recorded
0	Carpinteria Valley Water District Formation	Formation	2/10/1941		2/10/1941		Min 23/385-389	
1	Resolution 16388	Annexation	1/21/1957	16388	1/21/1957			
2	Louis C. Blau	Annexation	7/26/1966	1966-634		1966-13	2159/1103-1115	7/26/1966
3	Borgatello (Kaiser-Aetna)	Annexation	10/9/1973			1972-304	2487/0394-0406	10/9/1973
4	Miller Reorganization	Detachment	8/17/1994			1994-10	1994-0064734	8/17/1994
5	Rancho Monte Alegre	Annexation	4/20/2004			2003-02	2004-0039865	4/20/2004
6	Railroad Corridor	Annexation	9/10/2014			2013-08	2014-0041234	9/10/2014
	Carpinteria Valley Water District Sphere of Influence	SOI	3/1/2012					

RESOLUTION OF THE SANTA BARBARA LOCAL AGENCY FORMATION  
COMMISSION MAKING WRITTEN DETERMINATIONS AND CEQA FINDINGS AND  
REAFFIRMING THE SPHERE OF INFLUENCE FOR THE  
CASMALIA COMMUNITY SERVICES DISTRICT

WHEREAS, a Sphere of Influence is defined as a plan for the probable physical boundaries and service area of a city or special district as adopted by the Commission, and

WHEREAS, the Commission is required to review and update, as necessary, adopted spheres of influence not less than every five years, and

WHEREAS, the Commission is directed to conduct a review of municipal services not later than the time it considers an action to establish or update a sphere of influence, and

WHEREAS, the Commission conducted a municipal service review and adopted a Sphere of Influence for the Casmalia Community Services District on April 6, 2006, and reaffirmed the District's Sphere of Influence on November 4, 2010, and

WHEREAS, in the manner required by law, has given notice of the public hearing by the Commission to review and update the sphere of influence, and

WHEREAS, the Commission has heard, discussed and considered all relevant evidence, including but not limited to, the Executive Officer report, and environmental documents, applicable general and specific, plans and all testimony, correspondence and exhibits received during the public hearing, all of which are included hearing by reference,

NOW THEREFORE, IT IS RESOLVED DETERMINED AND ORDED as follows:

1. The project before the Commission is an update of the sphere of influence the Casmalia Community Services District.
2. The Commission finds this update to be exempt from CEQA because no change of the sphere of influence is being adopted.
3. The sphere of influence is hereby updated and no change is made to the map attached as Exhibit A
4. This resolution was adopted on January 4, 2018 and is effective on the date signed by the Chair.

AYES:

NOES:

ABSTAINS:

Dated: \_\_\_\_\_

\_\_\_\_\_  
Chair  
Santa Barbara Local Agency  
Formation Commission

ATTEST

\_\_\_\_\_  
Jacquelyne Alexander, Clerk  
Santa Barbara Local Agency Formation Commission

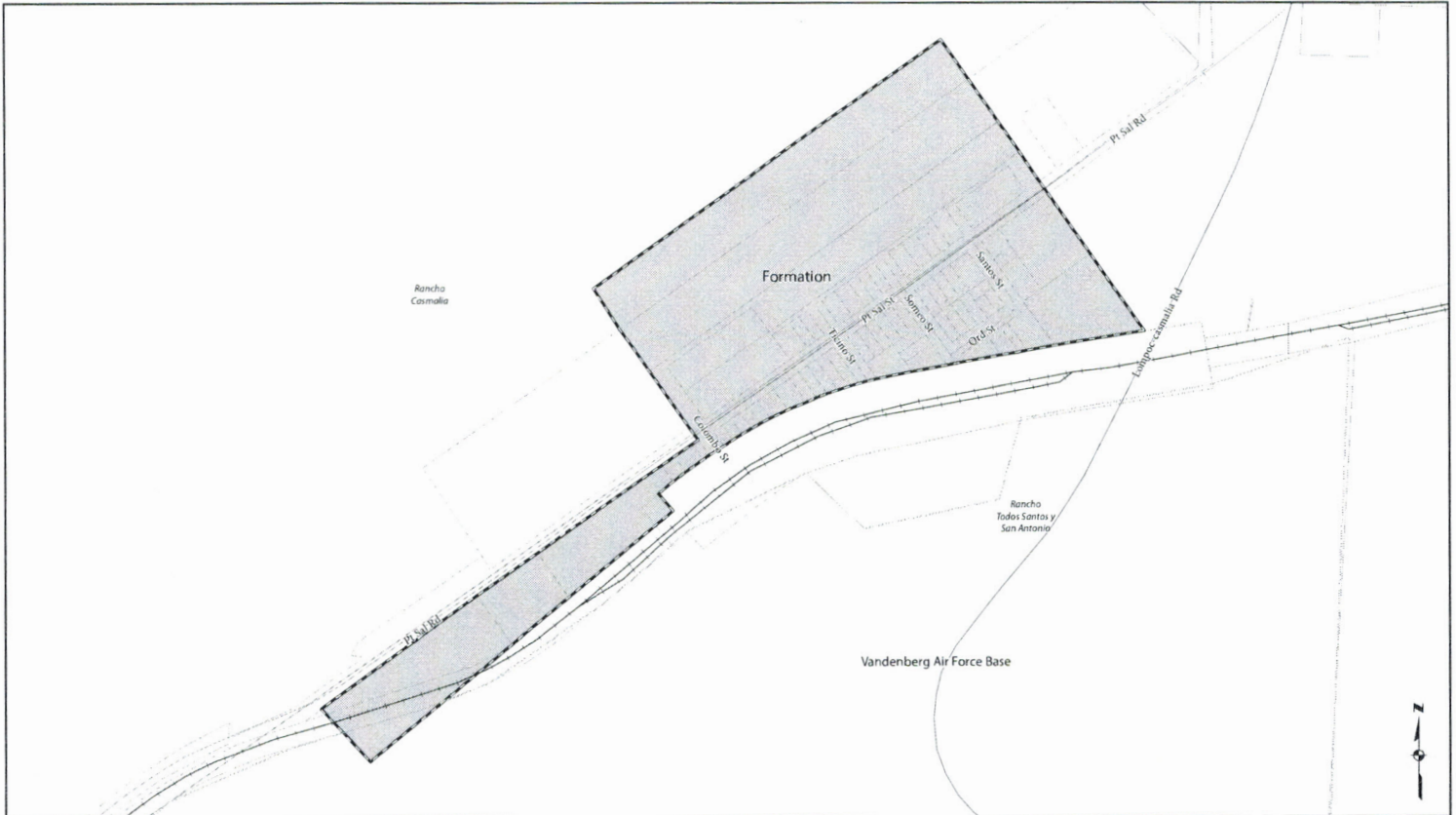

### Casmalia Community Services District

Compiled by the Office of the County Surveyor in October of 2010.  
 Formed by LAFCO Resolution 81-580, Recorded 4/23/1981.  
 See boundary activity table at <http://www.countyofsb.org/pwd/pwsurveyor.aspx?id=23260>

NOTICE OF DISCLAIMER: This data is for reference only. Although every effort has been made to ensure the accuracy of information, errors and conditions originating from physical sources used to develop the database may be reflected in this data. Santa Barbara County shall not be liable for any errors, omissions, or damages that result from inappropriate use of this document. No level of accuracy is claimed for the boundary lines shown hereon and lines should not be used to obtain coordinate values, bearings or distances.

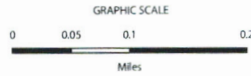

- Legend**
- Freeways
  - Highways
  - Roads
  - ▭ Parcels
  - ▭ Sections
  - Vandenberg Air Force Base
  - ▭ Ranchos and Townships
  - ▭ Sphere of Influence
  - ▭ Formation
  - ▭ Annexation
  - ▭ Detachment



### Casmalia Community Services District Boundary Activity

See map at <http://www.countyofsb.org/pwd/pwsurveyor.aspx?id=23260>

Internal No	Title	Type	Effective	LAFCO Res	LAFCO Date	Instrument	Recorded
0	Casmalia Community Services District Formation	Formation	4/23/1981	81-580	2/26/1981	1981-0016385	4/23/1981
	Casmalia CSDS sphere of influence	SCI	4/6/2006		4/4/2006		

10/12/2010



RESOLUTION OF THE SANTA BARBARA LOCAL AGENCY FORMATION  
COMMISSION MAKING WRITTEN DETERMINATIONS AND CEQA FINDINGS AND  
REAFFIRMING THE SPHERE OF INFLUENCE FOR THE  
CUYAMA COMMUNITY SERVICES DISTRICT

WHEREAS, a Sphere of Influence is defined as a plan for the probable physical boundaries and service area of a city or special district as adopted by the Commission, and

WHEREAS, the Commission is required to review and update, as necessary, adopted spheres of influence not less than every five years, and

WHEREAS, the Commission is directed to conduct a review of municipal services not later than the time it considers an action to establish or update a sphere of influence, and

WHEREAS, the Commission conducted a municipal service review and adopted a Sphere of Influence for the Cuyama Community Services District on April 6, 2006, and reaffirmed the District's Sphere of Influence on November 4, 2010, and

WHEREAS, in the manner required by law, has given notice of the public hearing by the Commission to review and update the sphere of influence, and

WHEREAS, the Commission has heard, discussed and considered all relevant evidence, including but not limited to, the Executive Officer report, and environmental documents, applicable general and specific, plans and all testimony, correspondence and exhibits received during the public hearing, all of which are included hearing by reference,

NOW THEREFORE, IT IS RESOLVED DETERMINED AND ORDED as follows:

1. The project before the Commission is an update of the sphere of influence the Cuyama Community Services District.
2. The Commission finds this update to be exempt from CEQA because no change of the sphere of influence is being adopted.
3. The sphere of influence is hereby updated and no change is made to the map attached as Exhibit A
4. This resolution was adopted on January 4, 2018 and is effective on the date signed by the Chair.

AYES:

NOES:

ABSTAINS:

Dated: \_\_\_\_\_

\_\_\_\_\_  
Chair  
Santa Barbara Local Agency  
Formation Commission

ATTEST

\_\_\_\_\_  
Jacquelyne Alexander, Clerk  
Santa Barbara Local Agency Formation Commission

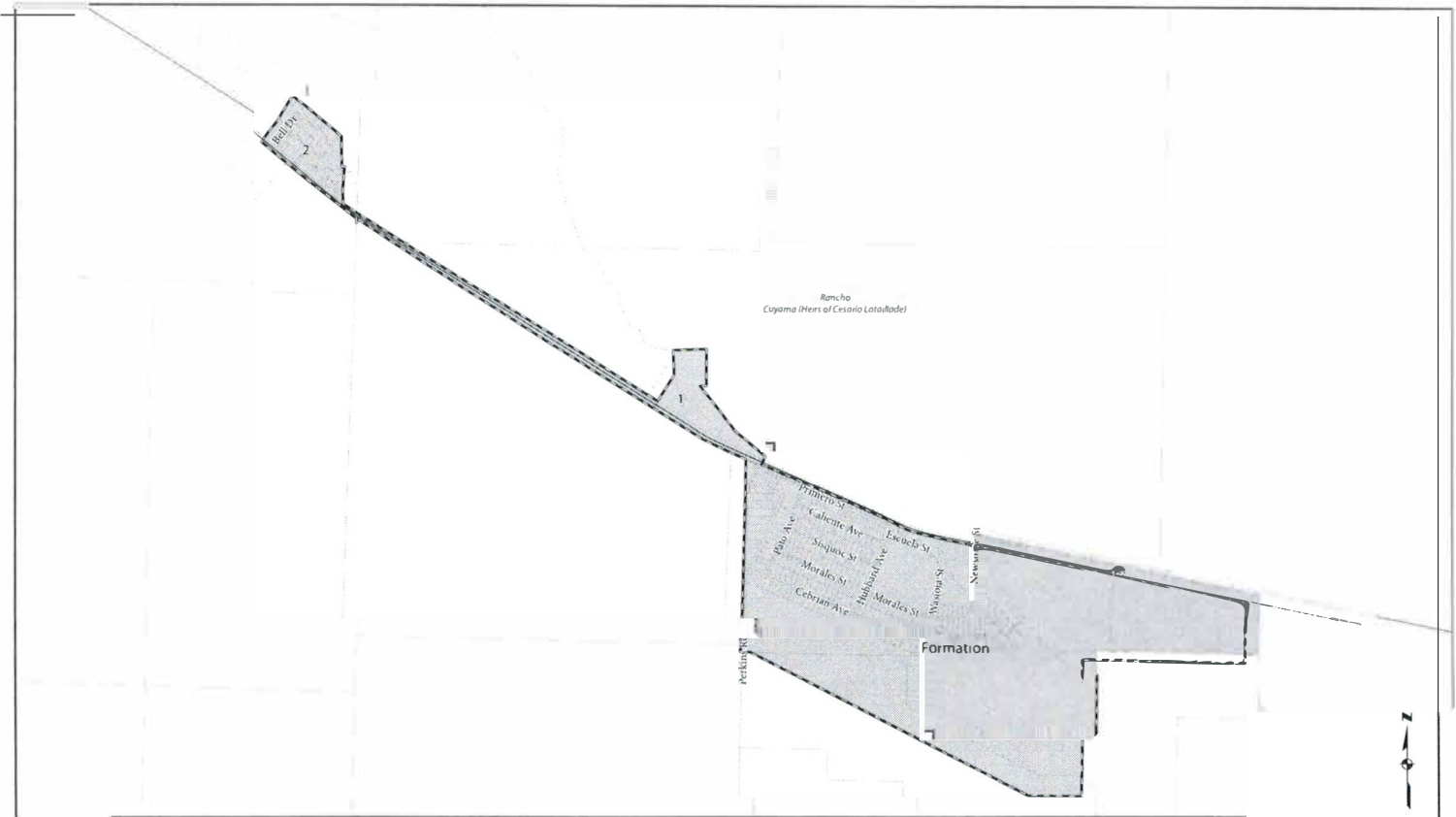

### Cuyama Community Services District

Compiled by the Office of the County Surveyor in December of 2010. Formed by LAFCO Resolution 77-554, Recorded 12/3/1977. Last Action: LAFCO 05-16 Ranchoho Annexation, 5/17/2006 Sphere: 4/6/2006. See boundary activity table at <http://www.countyofsb.org/pwd/pwsurveyor.aspx?id=23260>

NOTICE OF DISCLAIMER: This data is for reference only. Although every effort has been made to ensure the accuracy of information, errors and omissions originating from physical sources used to develop the database may be reflected in this data. Santa Barbara County shall not be liable for any errors, omissions, or damages that result from inappropriate use of this document. No level of accuracy is claimed for the boundary lines shown hereon and lines should not be used to obtain coordinate values, bearings or distances.



- Legend**
- Freeways
  - Highways
  - Roads
  - Parcels
  - Sections
  - ▭ Ranchos and Townships
  - ▭ Sphere of Influence
  - ▭ Formation
  - ▭ Annexation
  - ▭ Detachment



### Cuyama Community Services District

See map at <http://www.counityeds.org/pwd/pwsurveyor.aspx?id=23260>

InternalNo	Title	Type	Effective	LAFCO Res	LAFCO No	LAFCO Date	Instrument	Recorded
0	Cuyama Community Services District Formation	Formation	12/13/1977	77-458	77-FD-01	4/28/1977	1977-0061504	12/13/1977
1	Betty Annexation	Annexation	1/31/1995	94-04	94-04	1/16/1995	1995-0005327	1/31/1995
2	Rancholl	Annexation	5/17/2006	05-16	05-16	2-2-2006	2006-0039990	5/17/2006
	Cuyama CSD Sphere of Influence	SOI	4/6/2006			4/6/2006		

12/6/2010

RESOLUTION OF THE SANTA BARBARA LOCAL AGENCY FORMATION  
COMMISSION MAKING WRITTEN DETERMINATIONS AND CEQA FINDINGS AND  
REAFFIRMING THE SPHERE OF INFLUENCE FOR THE  
CUYAMA VALLEY RECREATION AND PARKS DISTRICT

WHEREAS, a Sphere of Influence is defined as a plan for the probable physical boundaries and service area of a city or special district as adopted by the Commission, and

WHEREAS, the Commission is required to review and update, as necessary, adopted spheres of influence not less than every five years, and

WHEREAS, the Commission is directed to conduct a review of municipal services not later than the time it considers an action to establish or update a sphere of influence, and

WHEREAS, the Commission conducted a municipal service review and adopted a Sphere of Influence for the Cuyama Valley Recreation and Parks District on April 6, 2006, and reaffirmed the District's Sphere of Influence on November 4, 2010, and

WHEREAS, in the manner required by law, has given notice of the public hearing by the Commission to review and update the sphere of influence, and

WHEREAS, the Commission has heard, discussed and considered all relevant evidence, including but not limited to, the Executive Officer report, and environmental documents, applicable general and specific, plans and all testimony, correspondence and exhibits received during the public hearing, all of which are included hearing by reference,

NOW THEREFORE, IT IS RESOLVED DETERMINED AND ORDERED as follows:

1. The project before the Commission is an update of the sphere of influence the Cuyama Valley Recreation and Parks District.
2. The Commission finds this update to be exempt from CEQA because no change of the sphere of influence is being adopted.
3. The sphere of influence is hereby updated and no change is made to the map attached as Exhibit A
4. This resolution was adopted on January 4, 2018 and is effective on the date signed by the Chair.

AYES:

NOES:

ABSTAINS:

Dated: \_\_\_\_\_

\_\_\_\_\_  
Chair  
Santa Barbara Local Agency  
Formation Commission

ATTEST

\_\_\_\_\_  
Jacquelyne Alexander, Clerk  
Santa Barbara Local Agency Formation Commission

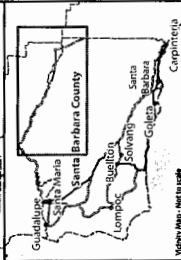
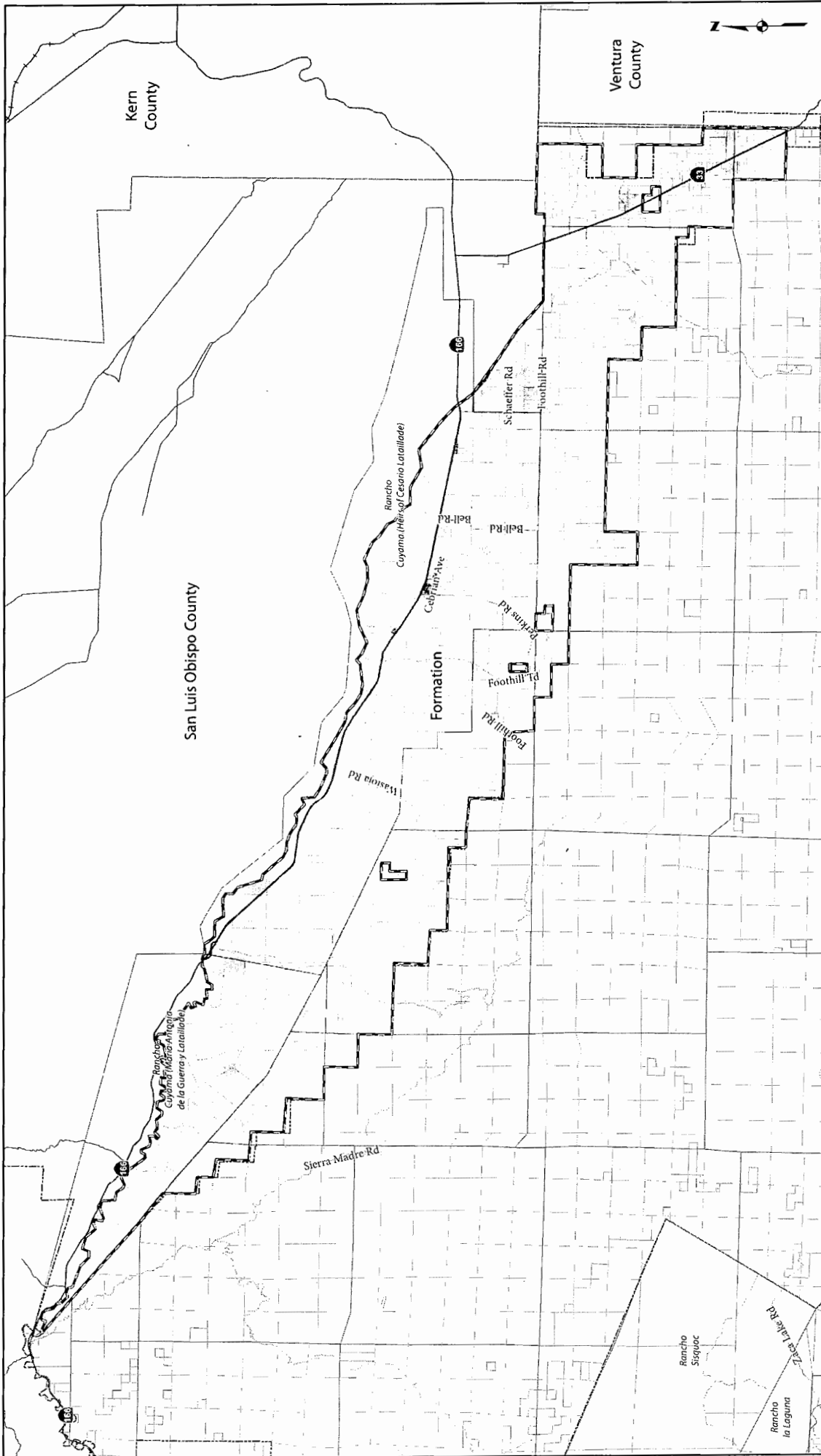

- Legend**
- Freeways
  - Highways
  - Roads
  - Railroads
  - ▭ Parcels
  - ▭ Cities
  - ▭ Sections
  - ▭ Los Padres National Forest
  - ▭ Ranchos and Townships
  - ▭ County Boundary
  - ▭ Sphere of Influence
  - ▭ Formation
  - ▭ Annexation
  - ▭ Detachment

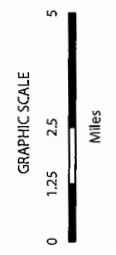

## Cuyama Valley Recreation and Park District

Compiled by the Office of the County Surveyor in August of 2010.  
 Formed by County Board of Supervisors Resolution 16269 on 12/17/1956.

NOTICE OF DISCLAIMER: This data is for reference only. Although every effort has been made to ensure the accuracy of information, errors or omissions may occur. The County Surveyor and the County Board of Supervisors will not be liable for any consequences or damages that result from inappropriate use of this document. No level of accuracy is claimed for the boundary lines shown hereon and they should not be used to obtain coordinate values, bearings or distances.



# Cuyama Valley Recreation and Park District Boundary Activity

InternalNo	Title	Type	Effective	County_Res	County_DT	LAFCO Date
0	Cuyama Valley Recreational District	Formation	12/17/1956	16269	12/17/1956	
	Cuyama Valley Recreation & Park Dist. Sphere of Influence	SOI	12/17/1956			4/6/2006



RESOLUTION OF THE SANTA BARBARA LOCAL AGENCY FORMATION  
COMMISSION MAKING WRITTEN DETERMINATIONS AND CEQA FINDINGS AND  
REAFFIRMING THE SPHERE OF INFLUENCE FOR THE  
EMBARCADERO MUNICIPAL IMPROVEMENT DISTRICT

WHEREAS, a Sphere of Influence is defined as a plan for the probable physical boundaries and service area of a city or special district as adopted by the Commission, and

WHEREAS, the Commission is required to review and update, as necessary, adopted spheres of influence not less than every five years, and

WHEREAS, the Commission is directed to conduct a review of municipal services not later than the time it considers an action to establish or update a sphere of influence, and

WHEREAS, the Commission conducted a municipal service review and adopted a Sphere of Influence for the Embarcadero Municipal Improvement District on September 1, 2005, and reaffirmed the District's Sphere of Influence on November 4, 2010, and

WHEREAS, in the manner required by law, has given notice of the public hearing by the Commission to review and update the sphere of influence, and

WHEREAS, the Commission has heard, discussed and considered all relevant evidence, including but not limited to, the Executive Officer report, and environmental documents, applicable general and specific, plans and all testimony, correspondence and exhibits received during the public hearing, all of which are included hearing by reference,

NOW THEREFORE, IT IS RESOLVED DETERMINED AND ORDED as follows:

1. The project before the Commission is an update of the sphere of influence the Embarcadero Municipal Improvement District.
2. The Commission finds this update to be exempt from CEQA because no change of the sphere of influence is being adopted.
3. The sphere of influence is hereby updated and no change is made to the map attached as Exhibit A
4. This resolution was adopted on January 4, 2018 and is effective on the date signed by the Chair.

AYES:

NOES:

ABSTAINS:

Dated: \_\_\_\_\_

\_\_\_\_\_  
Chair  
Santa Barbara Local Agency  
Formation Commission

ATTEST

\_\_\_\_\_  
Jacquelyne Alexander, Clerk  
Santa Barbara Local Agency Formation Commission



## Embarcadero Municipal Improvement District

Compiled by the Office of the County Surveyor in August of 2010.  
Formed by State Legislature in 1960 under authorization of the  
EMID Act (Stats. 1961, First Ex. Sess. 1960, ch. 81, p. 441.

NOTICE OF DISCLAIMER: This data is for reference only. Although every effort has been made to ensure the accuracy of information, errors and conditions originating from physical sources used to develop the database may be reflected in this data. Santa Barbara County shall not be liable for any errors, omissions, or damages that result from inappropriate use of this document. No level of accuracy is claimed for the boundary lines shown hereon and lines should not be used to obtain coordinate values, bearings or distances.

### Legend

- Freeways
- Roads
- Railroads
- Parcels
- Sections
- ▭ Ranchos and Townships
- ▭ Sphere of Influence
- ▭ Formation
- ▭ Annexation
- ▭ Detachment

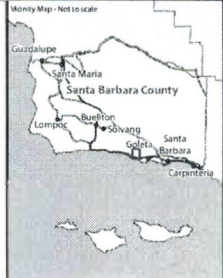

## Embarcadero Municipal Improvement District Boundary Activity

InternalNo	Title	Type	Effective Date	State Date	LAFCO Date	Notes
0	Embarcadero Municipal Service District Formation	Formation	7/7/1960	5/11/1960		EMID Act (Stats 1961, 1st Ex. Sess. 1960 ch. 8 p.441)
	Embarcadero Muni. Svc. Dist. Sphere of Influence	SOI	9/1/2005		9/1/2005	

8/18/2010

RESOLUTION OF THE SANTA BARBARA LOCAL AGENCY FORMATION  
COMMISSION MAKING WRITTEN DETERMINATIONS AND CEQA FINDINGS AND  
REAFFIRMING THE SPHERE OF INFLUENCE FOR THE  
ISLA VISTA RECREATION AND PARK DISTRICT

WHEREAS, a Sphere of Influence is defined as a plan for the probable physical boundaries and service area of a city or special district as adopted by the Commission, and

WHEREAS, the Commission is required to review and update, as necessary, adopted spheres of influence not less than every five years, and

WHEREAS, the Commission is directed to conduct a review of municipal services not later than the time it considers an action to establish or update a sphere of influence, and

WHEREAS, the Commission conducted a municipal service review and adopted a Sphere of Influence for the Isla Vista Recreation and Park District on September 1, 2005, and reaffirmed the District's Sphere of Influence on November 4, 2010, and

WHEREAS, in the manner required by law, has given notice of the public hearing by the Commission to review and update the sphere of influence, and

WHEREAS, the Commission has heard, discussed and considered all relevant evidence, including but not limited to, the Executive Officer report, and environmental documents, applicable general and specific, plans and all testimony, correspondence and exhibits received during the public hearing, all of which are included hearing by reference,

NOW THEREFORE, IT IS RESOLVED DETERMINED AND ORDED as follows:

1. The project before the Commission is an update of the sphere of influence the Isla Vista Recreation and Park District.
2. The Commission finds this update to be exempt from CEQA because no change of the sphere of influence is being adopted.
3. The sphere of influence is hereby updated and no change is made to the map attached as Exhibit A
4. This resolution was adopted on January 4, 2018 and is effective on the date signed by the Chair.

AYES:

NOES:

ABSTAINS:

Dated: \_\_\_\_\_

\_\_\_\_\_  
Chair  
Santa Barbara Local Agency  
Formation Commission

ATTEST

\_\_\_\_\_  
Jacquelyne Alexander, Clerk  
Santa Barbara Local Agency Formation Commission

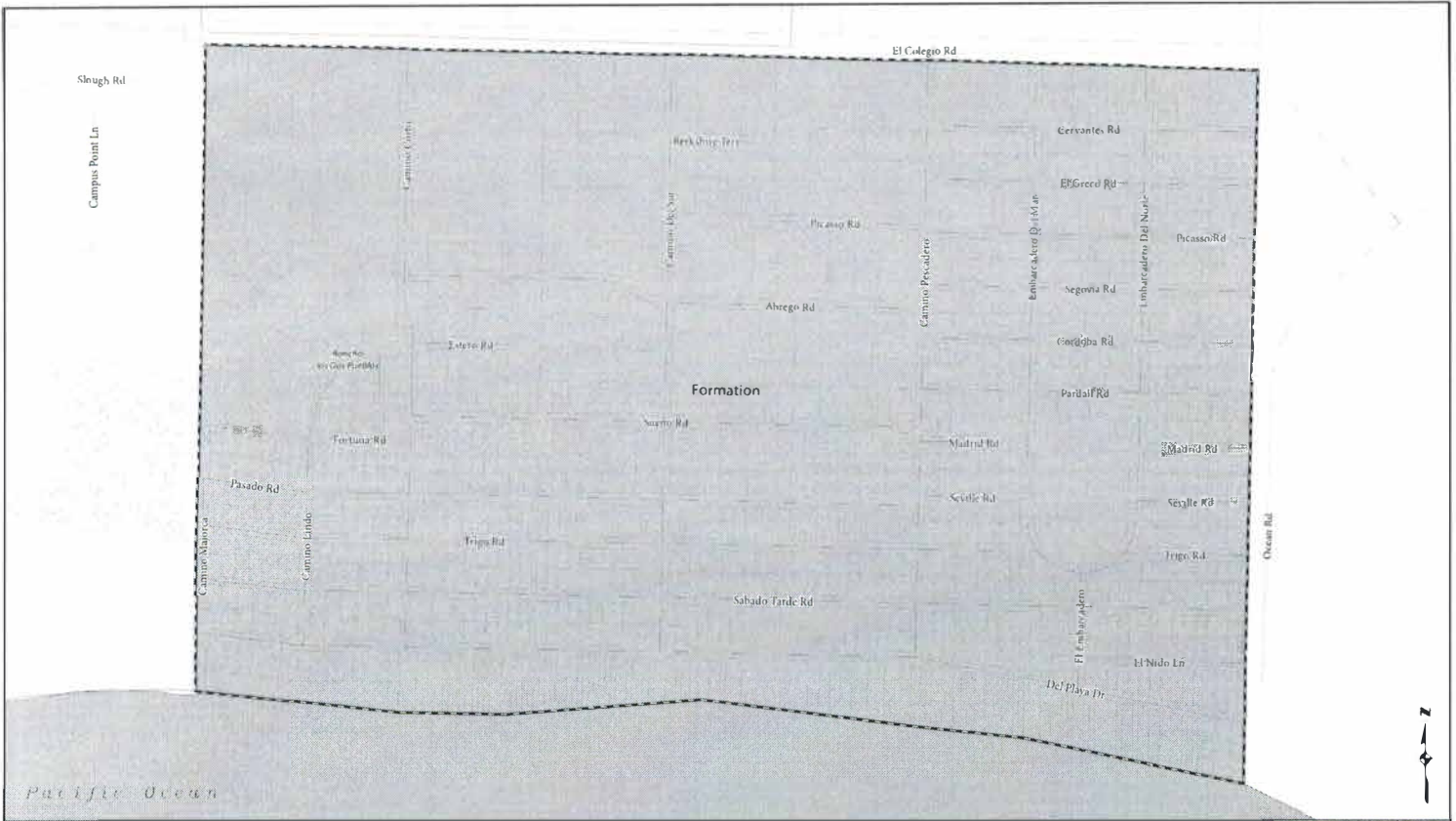

### Isla Vista Recreation and Park District

Compiled by the Office of the County Surveyor in August of 2010.  
 Formed by County Board of Supervisors Resolution 72-1163 on 11/6/1972.

NOTICE OF DISCLAIMER: This data is for reference only. Although every effort has been made to ensure the accuracy of estimation, errors and omissions originating from physical sources used to develop the database may be reflected in this data. Santa Barbara County shall not be liable for any errors, omissions, or damages that result from inappropriate use of this document. No level of accuracy is claimed for the boundary lines shown hereon and users should not be used to obtain coordinate values, bearings or distances.



#### Legend

- Freeways
- Highways
- Roads
- Railroads
- ▭ Parcels
- ▭ Cities
- ▭ Sections
- ▭ Ranchos and Townships
- ▭ Sphere of Influence
- ▭ Formation
- ▭ Annexation
- ▭ Detachment

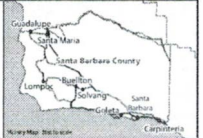

Isla Vista Recreation and Park District Boundary Activity

InternalNo	Title	Type	Effective	County Res	County DT	LAFCO Res	LAFCO Date
0	Isla Vista Recreation and Park District Formation	Formation	11/6/1972	72-1103	11/6/1972	287	2/4/1972
1	Recreation and Park District Sphere of Influence	SOI	9/1/2005				9/1/2005

8/19/2010



RESOLUTION OF THE SANTA BARBARA LOCAL AGENCY FORMATION  
COMMISSION MAKING WRITTEN DETERMINATIONS AND CEQA FINDINGS AND  
REAFFIRMING THE SPHERE OF INFLUENCE FOR THE  
LOMPOC VALLEY HEALTHCARE DISTRICT

WHEREAS, a Sphere of Influence is defined as a plan for the probable physical boundaries and service area of a city or special district as adopted by the Commission, and

WHEREAS, the Commission is required to review and update, as necessary, adopted spheres of influence not less than every five years, and

WHEREAS, the Commission is directed to conduct a review of municipal services not later than the time it considers an action to establish or update a sphere of influence, and

WHEREAS, the Commission conducted a municipal service review and adopted a Sphere of Influence for the Lompoc Valley Healthcare District on February 3, 2005, and reaffirmed the District's Sphere of Influence on November 4, 2010, and

WHEREAS, in the manner required by law, has given notice of the public hearing by the Commission to review and update the sphere of influence, and

WHEREAS, the Commission has heard, discussed and considered all relevant evidence, including but not limited to, the Executive Officer report, and environmental documents, applicable general and specific, plans and all testimony, correspondence and exhibits received during the public hearing, all of which are included hearing by reference,

NOW THEREFORE, IT IS RESOLVED DETERMINED AND ORDED as follows:

1. The project before the Commission is an update of the sphere of influence the Lompoc Valley Healthcare District.
2. The Commission finds this update to be exempt from CEQA because no change of the sphere of influence is being adopted.
3. The sphere of influence is hereby updated and no change is made to the map attached as Exhibit A
4. This resolution was adopted on January 4, 2018 and is effective on the date signed by the Chair.

AYES:

NOES:

ABSTAINS:

Dated: \_\_\_\_\_

\_\_\_\_\_  
Chair  
Santa Barbara Local Agency  
Formation Commission

ATTEST

\_\_\_\_\_  
Jacquelyne Alexander, Clerk  
Santa Barbara Local Agency Formation Commission

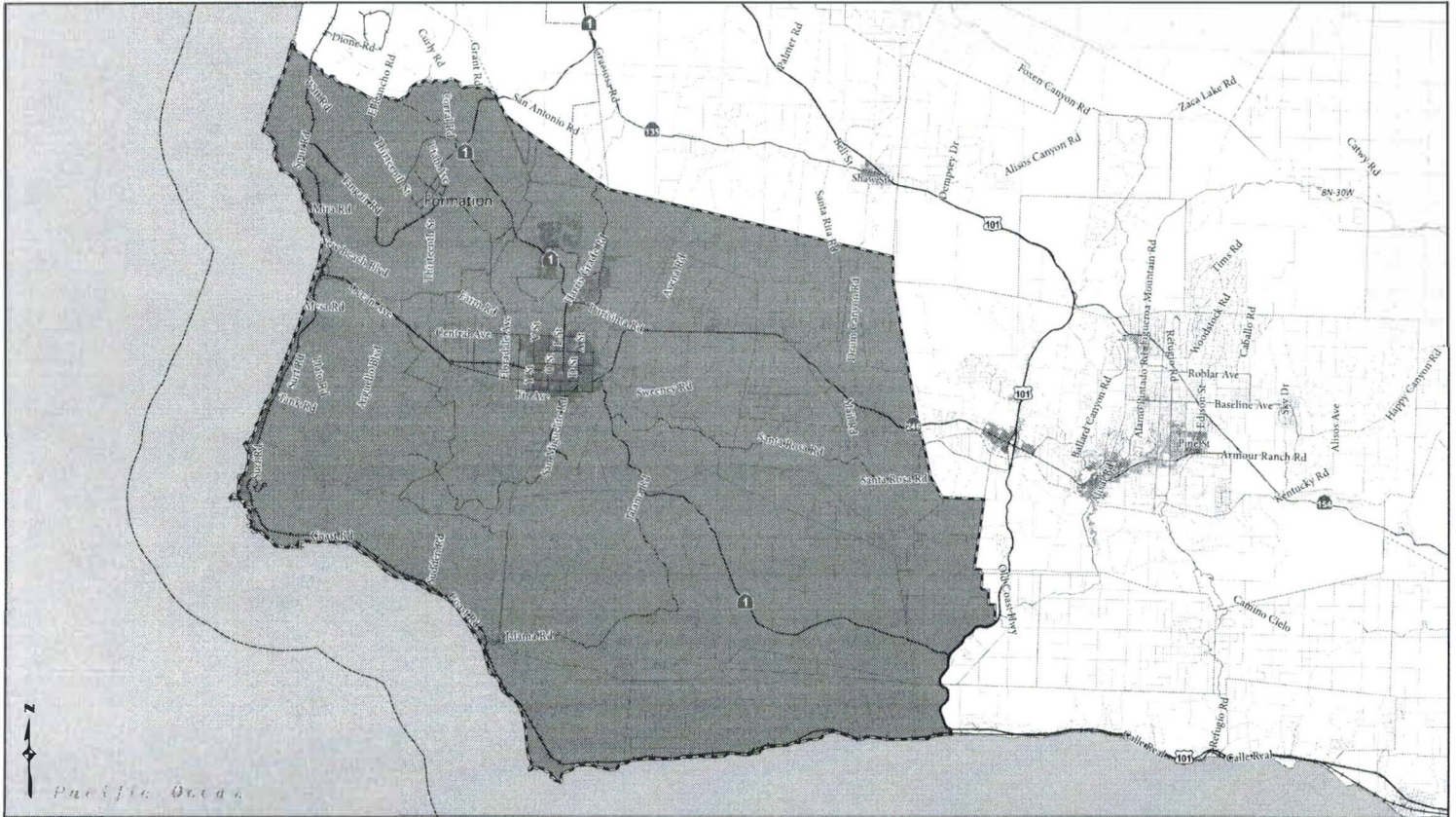

Pacific Ocean



### Lompoc Hospital District

Compiled by the Office of the County Surveyor in August of 2010.  
 Formed by County Board of Supervisors Resolution 6911 on 11/12/1946.

NOTICE OF DISCLAIMER: This data is for reference only. Although every effort has been made to ensure the accuracy of information, errors and omissions originating from physical sources used to develop the database may be reflected in this data. Santa Barbara County shall not be liable for any errors, omissions, or damages that result from inappropriate use of this document. No level of accuracy is claimed for the boundary lines shown herein and there should not be used to obtain coordinate values, bearings or distances.

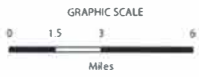

#### Legend

- Freeways
  - Highways
  - Roads
  - Railroads
  - Parcels
- Sections
  - Vandenberg Air Force Base
  - Ranchos and Townships
  - County Boundary
  - Sphere of Influence
- Formation
  - Annexation
  - Detachment

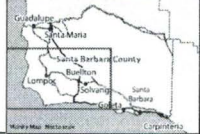

## Lompoc Hospital District Boundary Activity

<b>InternalNo</b>	<b>Title</b>	<b>Type</b>	<b>Effective</b>	<b>County_Res</b>	<b>County_DT</b>	<b>LAFCO_Date</b>
0	Lompoc Hospital District Formation	Formation	11/12/1946	6911	11/12/1946	
	Lompoc Hospital District Sphere of Influence	SOI	2/3/2005			2/3/2005

8/12/2010

LAFCO 18-

RESOLUTION OF THE SANTA BARBARA LOCAL AGENCY FORMATION  
COMMISSION MAKING WRITTEN DETERMINATIONS AND CEQA FINDINGS AND  
REAFFIRMING THE SPHERE OF INFLUENCE FOR THE  
LOS ALAMOS COMMUNITY SERVICES DISTRICT

WHEREAS, a Sphere of Influence is defined as a plan for the probable physical boundaries and service area of a city or special district as adopted by the Commission, and

WHEREAS, the Commission is required to review and update, as necessary, adopted spheres of influence not less than every five years, and

WHEREAS, the Commission is directed to conduct a review of municipal services not later than the time it considers an action to establish or update a sphere of influence, and

WHEREAS, the Commission conducted a municipal service review and adopted a Sphere of Influence for the Los Alamos Community Services District on August 3, 2006, and reaffirmed the District's Sphere of Influence on November 4, 2010, and

WHEREAS, in the manner required by law, has given notice of the public hearing by the Commission to review and update the sphere of influence, and

WHEREAS, the Commission has heard, discussed and considered all relevant evidence, including but not limited to, the Executive Officer report, and environmental documents, applicable general and specific, plans and all testimony, correspondence and exhibits received during the public hearing, all of which are included hearing by reference,

NOW THEREFORE, IT IS RESOLVED DETERMINED AND ORDED as follows:

1. The project before the Commission is an update of the sphere of influence the Los Alamos Community Services District.
2. The Commission finds this update to be exempt from CEQA because no change of the sphere of influence is being adopted.
3. The sphere of influence is hereby updated and no change is made to the map attached as Exhibit A
4. This resolution was adopted on January 4, 2018 and is effective on the date signed by the Chair.

AYES:

NOES:

ABSTAINS:

Dated: \_\_\_\_\_

\_\_\_\_\_  
Chair  
Santa Barbara Local Agency  
Formation Commission

ATTEST

\_\_\_\_\_  
Jacquelyne Alexander, Clerk  
Santa Barbara Local Agency Formation Commission

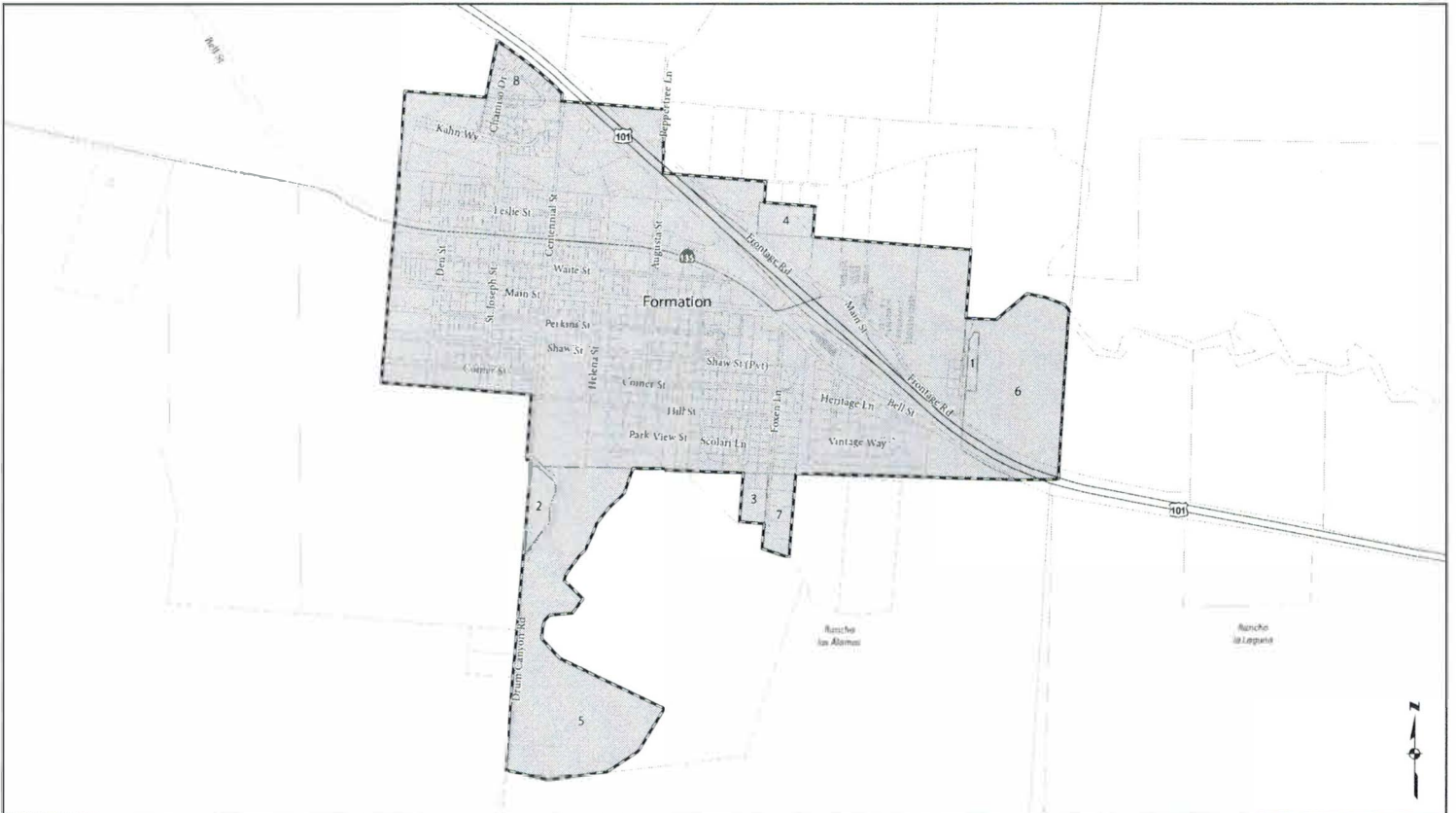

### Los Alamos Community Services District

Compiled by the Office of the County Surveyor in October of 2010. Formed by Board of Supervisors Resolution 16160, 10/29/1956 Last Action: LAFCO 02-05, Hanly Annex, 6/20/2002. See boundary activity table at <http://www.countyofsb.org/pwd/pwsurveyor.aspx?id=23260>

NOTICE OF DISCLAIMER: This data is for reference only. Although every effort has been made to ensure the accuracy of information, errors and conditions originating from third party sources used to develop the database may be reflected in this data. Santa Barbara County shall not be liable for any errors, omissions, or damages that result from inappropriate use of this document. No level of accuracy is claimed for the boundary lines shown hereon and they should not be used to obtain coordinate values, bearings or distances.



- Legend**
- Freeways
  - Highways
  - Roads
  - ▭ Parcels
  - ▭ Sections
- Ranchos and Townships**
- ▭ Sphere of influence
  - ▭ Formation
  - ▭ Annexation
  - ▭ Detachment

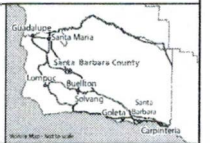

# Los Alamos Community Services District Boundary Activity

See map at <http://www.countyofsb.org/pwef/pwefmap.aspx?id=23260>

Internal No	Title	Type	Effective	County Res.	County DT	LAFCO Res.	LAFCO Date	Instrument	Recorded
0	Los Alamos CSD Formation	Formation	10/29/1956	16160	10/29/1956				
1	Serpa & Gonzales	Annexation	6/15/1965					210871845-9	6/15/1965
2	Water Storage Tank	Annexation	6/15/1965					210871845-9	6/15/1965
3	Zoellner	Annexation	4/17/1972			200		23957944-804	4/17/1972
4	Skyview	Annexation	4/17/1972			227		23957944-804	4/17/1972
5	Los Alamos Park	Annexation	3/22/1979			78-513		1979-0012653	3/22/1979
6	Carrari	Annexation	4/26/1989			88-775		1989-0027332	4/26/1989
7	Proxm Acres	Annexation	6/20/1994			92-04		1994-0054427	6/30/1994
8	Hainly	Annexation	6/20/2002			02-05		2002-00660051	6/30/2002
	Los Alamos CSD Sphere of Influence	SOI	8/3/2006				8/3/2006		

10/12/2010



RESOLUTION OF THE SANTA BARBARA LOCAL AGENCY FORMATION  
COMMISSION MAKING WRITTEN DETERMINATIONS AND CEQA FINDINGS AND  
REAFFIRMING THE SPHERE OF INFLUENCE FOR THE  
MISSION HILLS COMMUNITY SERVICES DISTRICT

WHEREAS, a Sphere of Influence is defined as a plan for the probable physical boundaries and service area of a city or special district as adopted by the Commission, and

WHEREAS, the Commission is required to review and update, as necessary, adopted spheres of influence not less than every five years, and

WHEREAS, the Commission is directed to conduct a review of municipal services not later than the time it considers an action to establish or update a sphere of influence, and

WHEREAS, the Commission conducted a municipal service review and adopted a Sphere of Influence for the Mission Hills Community Services District on February 3, 2005, and reaffirmed the District's Sphere of Influence on November 4, 2010, and

WHEREAS, in the manner required by law, has given notice of the public hearing by the Commission to review and update the sphere of influence, and

WHEREAS, the Commission has heard, discussed and considered all relevant evidence, including but not limited to, the Executive Officer report, and environmental documents, applicable general and specific, plans and all testimony, correspondence and exhibits received during the public hearing, all of which are included hearing by reference,

NOW THEREFORE, IT IS RESOLVED DETERMINED AND ORDED as follows:

1. The project before the Commission is an update of the sphere of influence the Mission Hills Community Services District.
2. The Commission finds this update to be exempt from CEQA because no change of the sphere of influence is being adopted.
3. The sphere of influence is hereby updated and no change is made to the map attached as Exhibit A
4. This resolution was adopted on January 4, 2018 and is effective on the date signed by the Chair.

AYES:

NOES:

ABSTAINS:

Dated: \_\_\_\_\_

\_\_\_\_\_  
Chair  
Santa Barbara Local Agency  
Formation Commission

ATTEST

\_\_\_\_\_  
Jacquelyne Alexander, Clerk  
Santa Barbara Local Agency Formation Commission



## Mission Hills Community Services District Boundary Activity

See map at <http://www.countyofsb.org/pwd/pwsurveyor.aspx?id=23260>

InternalNo	Title	Type	Effective	BOS_Res	BOS_Date	Dist_Res	Dist_Date	LAFCO_No	LAFCO_Res	LAFCO_Date	Instrument	Recorded
0	Mission Hills CSD Formation	Formation	11/26/1979	79-613	11/26/1979			79-FD-01	79-535	8/1/1979	1979-0056146	11/29/1979
1	Parcels 97-380-37 & -38	Annexation	1/9/1986			65	12/18/1985	84-AD-20	85-710	12/11/1985	1986-0001547	1/9/1986
2	Tract 13,759 (Gherini)	Annexation	1/21/1987			73	1/7/1987	86-AD-19	86-741	12/11/1986	1987-0004861	1/21/1987
3	Rucker Ponds	Annexation	12/3/1987			78	11/18/1987	87-AD-1	87-760	11/5/1987	1987-0089034	12/3/1987
4	St. Mary's Episcopal Church	Annexation	4/26/1995					94-24	94-24	2/9/1995	1995-0022527	4/26/1995
5	Black Annexation	Annexation	6/17/1996					95-12	95-12	10/5/1995	1996-0036764	6/17/1996
6	Martin Farrell Homes	Annexation	9/26/2001					99-05	99-05	2/1/2001	2001-0082619	9/26/2001
7	Bluffs at Mission Oaks	Annexation	6/3/2003					02-11	02-11	10/10/2002	2003-0071935	6/3/2003
8	Burton Mesa Public Safety	Annexation	4/19/2007					07-01	07-01	2/1/2007	2007-0029228	4/19/2007
9	Burton Ranch Reorg.	Annexation	5/31/2007					06-05	06-05	6/30/2006	2007-0040552	5/13/2007
10	Kaehn Annexation	Annexation	7/9/2014					14-02	14-02	6/5/2014	2014-0030937	7/9/2014
11	Summit View Homes Reorg.	Annexation	2/24/2016					14-01	16-01	1/7/2016	2016-0007116	2/24/2016
	Mission Hills CSD Sphere of Influence	SOI	1/7/2016							1/7/2016		

LAFCO 18-

RESOLUTION OF THE SANTA BARBARA LOCAL AGENCY FORMATION  
COMMISSION MAKING WRITTEN DETERMINATIONS AND CEQA FINDINGS AND  
REAFFIRMING THE SPHERE OF INFLUENCE FOR THE  
MOSQUITO AND VECTOR CONTROL DISTRICT OF SANTA BARBARA COUNTY

WHEREAS, a Sphere of Influence is defined as a plan for the probable physical boundaries and service area of a city or special district as adopted by the Commission, and

WHEREAS, the Commission is required to review and update, as necessary, adopted spheres of influence not less than every five years, and

WHEREAS, the Commission is directed to conduct a review of municipal services not later than the time it considers an action to establish or update a sphere of influence, and

WHEREAS, the Commission conducted a municipal service review and adopted a Sphere of Influence for the Mosquito and Vector Control District of Santa Barbara County on February 3, 2005, and reaffirmed the District's Sphere of Influence on November 4, 2010, and

WHEREAS, in the manner required by law, has given notice of the public hearing by the Commission to review and update the sphere of influence, and

WHEREAS, the Commission has heard, discussed and considered all relevant evidence, including but not limited to, the Executive Officer report, and environmental documents, applicable general and specific, plans and all testimony, correspondence and exhibits received during the public hearing, all of which are included hearing by reference,

NOW THEREFORE, IT IS RESOLVED DETERMINED AND ORDERED as follows:

1. The project before the Commission is an update of the sphere of influence the Mosquito and Vector Control District of Santa Barbara County.
2. The Commission finds this update to be exempt from CEQA because no change of the sphere of influence is being adopted.
3. The sphere of influence is hereby updated and no change is made to the map attached as Exhibit A
4. This resolution was adopted on January 4, 2018 and is effective on the date signed by the Chair.

AYES:

NOES:

ABSTAINS:

Dated: \_\_\_\_\_

\_\_\_\_\_  
Chair  
Santa Barbara Local Agency  
Formation Commission

ATTEST

\_\_\_\_\_  
Jacquelyne Alexander, Clerk  
Santa Barbara Local Agency Formation Commission

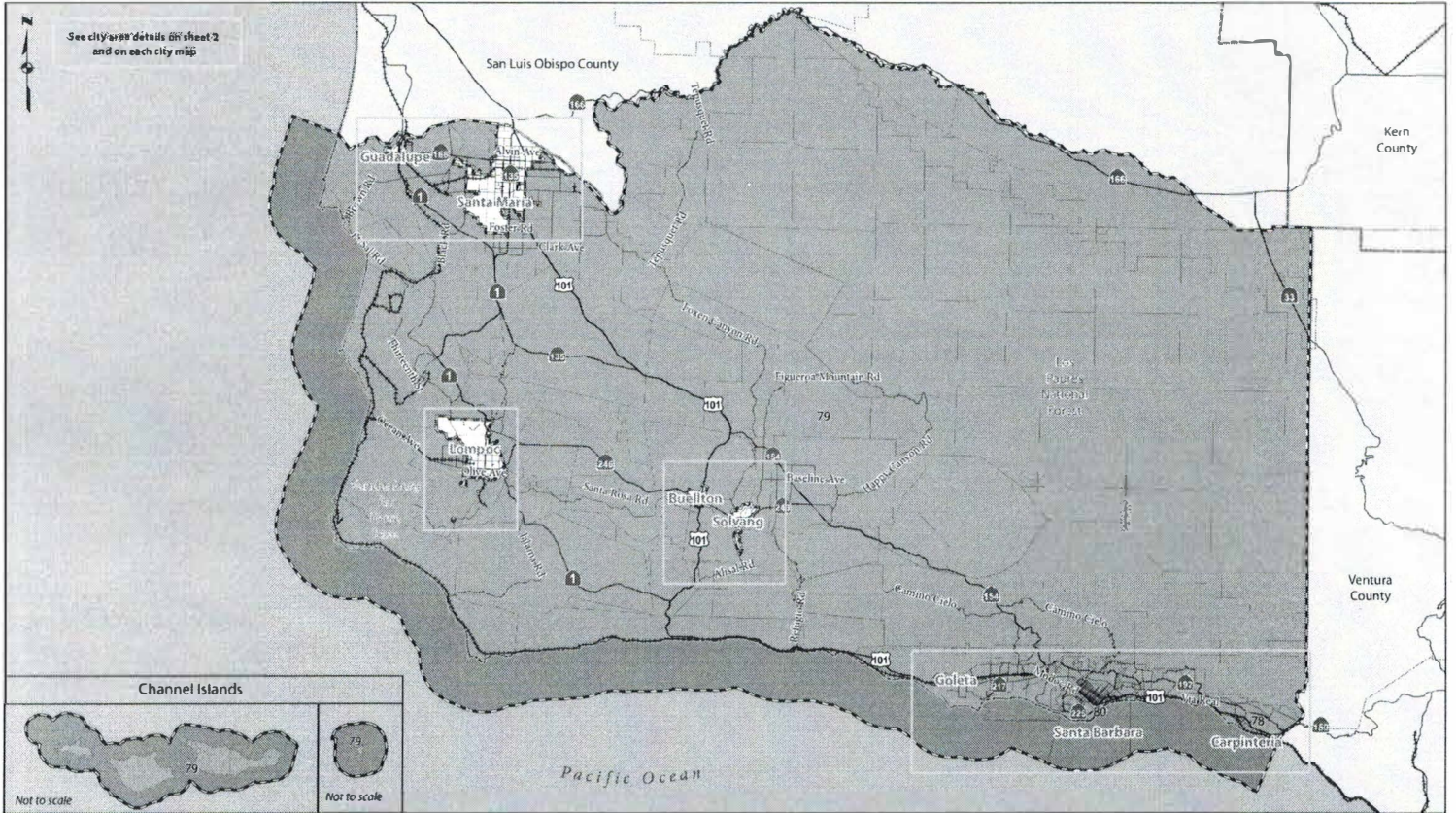

**Mosquito and Vector Management District of Santa Barbara County—Overview**

Compiled by the County Surveyor's Office on 12/28/2016. Formed as Isla Vista Mosquito Abatement District by County Res. 18864, 1/26/1959. Last Action: 88, Summit View Homes Reorg., IAFCO 14-01, 2016-0008389, 2/24/2016. Sphere: 11/4/2010. See boundary activity table at <http://www.countyofsb.org/pwd/pwsurveyor.aspx?id=23260>

See city area details on sheet 2 and on each city map. Action numbers 1-77 and 82 are not depicted.

NOTICE OF DISCLAIMER: This data is for reference only. Although every effort has been made to ensure the accuracy of information shown and conditions originating from physical sources used to develop the database may be reflected in this data, Santa Barbara County shall not be liable for any errors, omissions, or damages that result from independent use of this document. No level of accuracy is claimed for the boundary lines shown herein and lines should not be used to obtain coordinate values, bearings, or distances.

**GRAPHIC SCALE**  
0 2.5 5 10  
Miles

**Legend**

- Freeways
- Highways
- Roads
- Railroads
- Cities
- Sections
- Ranchos and Townships
- Vandenberg Air Force Base
- Los Padres National Forest
- County Boundary
- Sphere of Influence
- Formation
- Annexation
- Detachment

Map 1 of 2

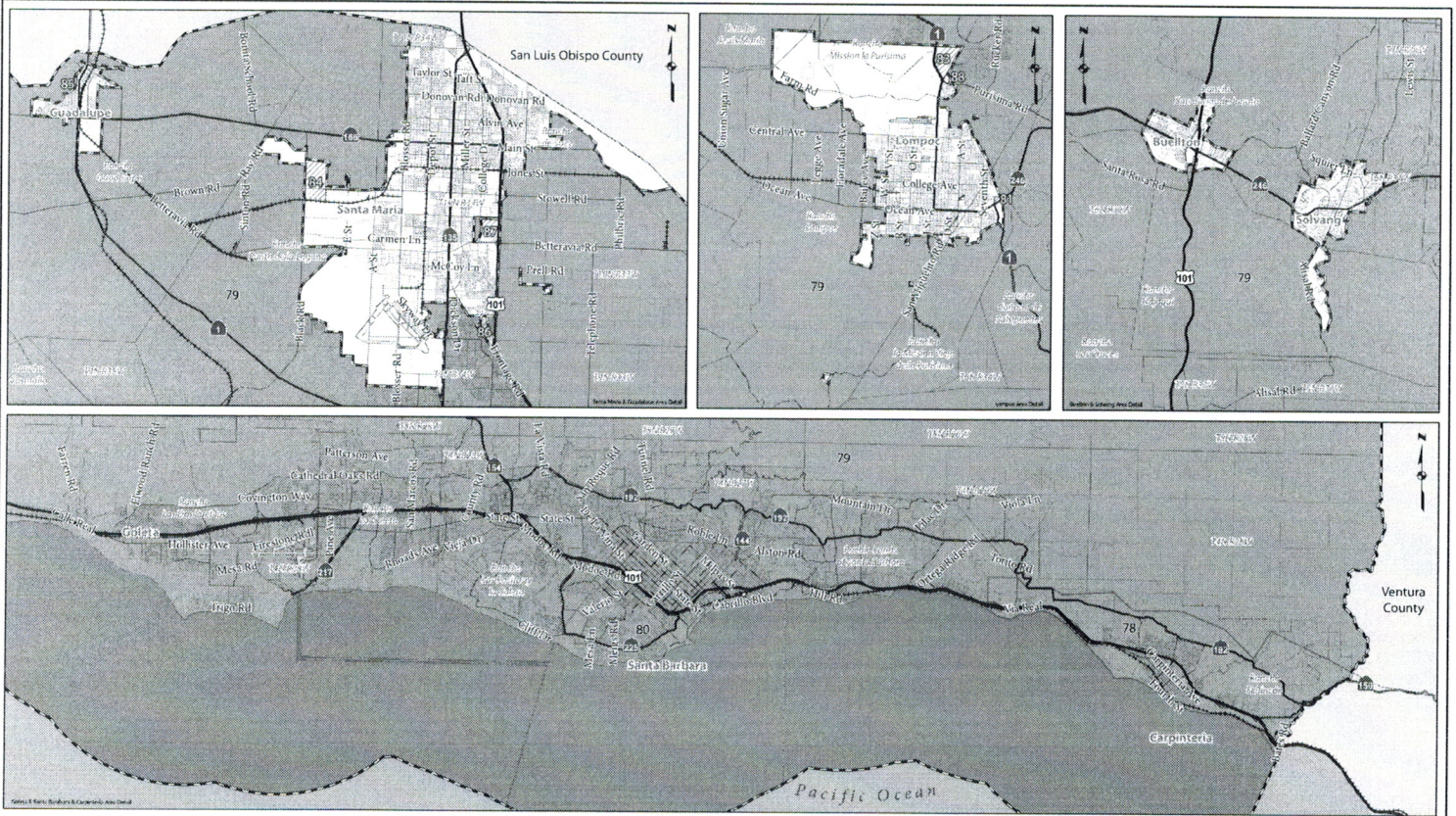

### Mosquito and Vector Management District of Santa Barbara County—City Details

Compiled by the County Surveyor's Office on 12/28/2016. Formed as Isla Vista Mosquito Abatement District by County Res. 18864, 1/26/1959. Last Action: 88, Summit View Homes Reorg., LAFCD 14-01, 2016-0008389, 2/24/2016. Sphere: 11/4/2010. See boundary activity table at <http://www.countyofsb.org/pwd/pwsurveyor.aspx?id=23260>

See overview on sheet 1. Action numbers 1-77 and 82 are not depicted.  
 NOTICE OR DISCLAIMER: This data is for reference only. Although every effort has been made to ensure the accuracy of information, errors and conditions originating from physical sources used to develop the database may be reflected in this data. Santa Barbara County shall not be liable for any errors, omissions, or damages that result from inappropriate use of this document. No level of accuracy is claimed for the boundary lines shown hereon and lines should not be used to obtain coordinate values, bearings or distances.

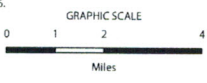

- Legend**
- Freeways
  - Highways
  - Roads
  - Railroads
  - Cities
  - ▭ Parcels
  - ▭ Sections
  - ▭ Ranchos and Townships
  - ▭ Vandenberg Air Force Base
  - ▭ Los Padres National Forest
  - ▭ County Boundary
  - ▭ Sphere of Influence
  - ▭ Formation
  - ▭ Annexation
  - ▭ Detachment

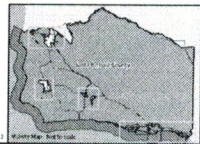



## Mosquito and Vector Management District of Santa Barbara County Boundary Activity

Only actions with numbers in bold are depicted on the map.

See map at <http://www.countyofsb.org/pwd/pwsurveyor.aspx?id=23260>

Abbreviations: Res, Resolution, DT, Date, CS, County Surveyor, WO, Work Order, T, Tract, Reorg, Reorganization

InternalNo	Title	Type	Effective	County_Res	County_DT	Dist_Res	Dist_DT	LAFCO_No	LAFCO_Res	LAFCO_DT	Instrument	Recorded	State_DT	CSWO	WO_DT
1	Isla Vista Mosquito Abatement Dist. Formation	Formation	1/26/1959	18664	1/26/1959									197	12/3/1958
2	More Mesa Improvement Association	Annexation	9/12/1960			3	9/12/1960							379	7/11/1960
	Renamed Goleta Valley Mosquito Abatement	Renaming	7/17/1961	21505	7/17/1961										
3	Winchester Homes Inc., T10235, Unit 1	Annexation	12/17/1962	22529	9/4/1962	10	12/17/1962							617	6/4/1962
4	James B. Canby, etux, T10236	Annexation	12/17/1962	22619	10/8/1962	11	12/17/1962							675	9/4/1962
5	Winchester Homes, Inc., T10235, Unit 2	Annexation	1/14/1963	22674	10/29/1962	12	1/14/1963							687	10/1/1962
6	Davis-McKee, Inc., T10154, Unit 2	Annexation	1/14/1963	22640	10/15/1962	13	1/14/1963							690	
7	Goleta Valley Development Co., T10251	Annexation	3/11/1963	22752	11/8/1962	19	3/11/1963							707	
8	Rancho San Antonio, T10256	Annexation	3/11/1963	22754	12/3/1962	20	3/11/1963							710	
9	Rowe Property, T10245	Annexation	5/13/1963	22291	3/11/1963	29	5/13/1963							773	
10	Halnor, Inc., Tract 10206, Unit 1	Annexation	4/8/1963	22820	1/7/1963	21	4/8/1963							664	
11	Goleta Valley Development Co., T10257	Annexation	4/8/1963	22824	1/7/1963	22	4/8/1963							725	
12	Pyramid Certified Projects, T10258	Annexation	4/8/1963	22827	1/7/1963	23	4/8/1963							728	
13	Lucia V. Hilton, T10266	Annexation	5/13/1963	22905	2/4/1963	31	5/13/1963							718	
14	Eli Luria, etux, T10253	Annexation	5/13/1963	23012	3/18/1963	30	5/13/1963							772	
15	Twains-Wittenburg Co., T10268	Annexation	5/13/1963	23014	3/18/1963	32	5/13/1963							776	
16	John T. Oxley, T10269, Unit 1	Annexation	5/13/1963	23016	3/18/1963	33	5/13/1963							744	12/17/1962
17	Winchester Homes, Inc., T10235, Unit 3	Annexation	7/8/1963	23115	4/29/1963	36	7/8/1963							804	3/25/1963
18	Ranch Development Co., T10267	Annexation	7/8/1963	23082	4/15/1963	37	7/8/1963							795	
19	John A. Lucian, Fairview Commercial	Annexation	8/12/1963	23236	6/17/1963	43	8/12/1963							832	
20	William D. Cronin, etal, T10272	Annexation	8/12/1963	23234	6/17/1963	45	8/12/1963							835	
21	Phillip Harman, T10293	Annexation	8/12/1963	23235	6/17/1963	47	8/12/1963							843	
22	Spears and Hunter, T10232	Annexation	8/12/1963	23142	5/13/1963	44	8/12/1963							823	
23	Goleta Valley Development Co., T10278	Annexation	8/12/1963	23176	5/27/1963	46	8/12/1963							831	
24	T10051, Units 1-10, T10116, T10061, Holiday Park Units 1&2	Annexation	10/14/1963	23279	7/1/1963	56	10/14/1963							856	
25	Carnage Hill, T10295	Annexation	10/14/1963	23278	7/1/1963	57	10/14/1963					1/27/1964		854	
26	La Cumbre Development Co., T10305	Annexation	10/14/1963	23355	7/29/1963	60	10/14/1963							881	
27	Winchester Homes, Inc., T10235, Unit 4	Annexation	10/14/1963	23354	7/29/1963	62	10/14/1963							876	
28	Cameo Park, T10260	Annexation	10/14/1963	23314	7/15/1963	58	10/14/1963							864	

InternalNo	Title	Type	Effective	County_Res	County_DT	Dist_Res	Dist_DT	LAFCO No	LAFCO Res	LAFCO_DT	Instrument	Recorded	State_DT	CSWO
29	Butler-Habour, Inc., T10223, Unit 2	Annexation	10/14/1963	23330	7/22/1963	59	10/14/1963							873
30	Roseglen Construction Co., T10306	Annexation	10/14/1963	23356	7/29/1963	60	10/14/1963							872
31	John R. Cox, T10316	Annexation	12/9/1963	23490	9/23/1963	71	12/9/1963							911
32	John T. Oxley, T10269, Unit 2	Annexation	12/9/1963	23460	9/16/1963	72	12/9/1963							900
33	Butler-Habour, Inc., T10223, Unit 2	Annexation	12/9/1963	23508	9/30/1963	73	12/9/1963							912
34	Southland Development Co., T10311	Annexation	12/9/1963	23458	10/15/1963	74	12/9/1963							946
35	Paul M. Gaior, T10331	Annexation	12/9/1963	23549	10/15/1963	75	12/9/1963							920
36	Winchester Homes, Inc.	Annexation	12/9/1963	23546	10/15/1963	76	12/9/1963							928
37	Ralph C. Day	Annexation	12/9/1963	23457	10/15/1963	77	12/9/1963							925
38	Francis J. McGowan, etal, T10338	Annexation	12/9/1963	23550	10/15/1963	78	12/9/1963							932
39	J. H. Barton Construction Co., T10334	Annexation	11/13/1964	23648	11/26/1963	80	11/13/1964							965
40	Leo M. Sanders	Annexation	4/13/1964	23811	2/10/1964	85	4/13/1964							976
41	Ray Martin & Associates, T10318	Annexation	4/13/1964	23819	2/17/1964	86	4/13/1964							979
42	Dwight Investment Corp., T10320	Annexation	4/13/1964	23837	2/24/1964	87	4/13/1964							998
43	William Koart, T10341	Annexation	4/13/1964	23841	2/24/1964	88	4/13/1964							989
44	Luria Development Co., T10326	Annexation	6/18/1964	23905	3/23/1964	92	6/8/1964							1001
45	Hollister Ave. & Ward Memorial	Annexation	6/8/1964	23963	4/27/1964	94	6/8/1964							1016
46	Carolale, Inc., T10347	Annexation	10/8/1964	23951	4/20/1964	93	10/8/1964							1004
47	Mabel Rathbun Wells, T10283	Annexation	9/14/1964	24044	6/1/1964	96	9/14/1964							1027 4/6/1964
48	Albert Vido	Annexation	11/9/1964	24129	7/13/1964	100	11/9/1964							1040 5/25/1964
49	Marie A. Behrendt	Annexation	11/9/1964	24200	8/10/1964	101	11/9/1964							1043 6/8/1964
50	Ron L. Wolfe, Goleta Valley	Annexation	12/21/1964	24370	11/16/1964	104	12/21/1964							1056 10/13/1964
51	Goleta Valley Dev. Co., T10699, Unit 1	Annexation	4/22/1968				4/8/1968	1968-AD-04	1968-82	3/28/1968	2229/0518-0525	4/22/1968	4/10/1968	
52	Walker-Built Homes, T10660	Annexation	8/28/1968				107	7/8/1968	1967-AD-14	1968-94	6/13/1968	2243/0810-0820	8/28/1968	8/14/1968
53	William Koart, T10818	Annexation	12/30/1968				108	12/20/1968	1968-AD-20	1968-117	12/12/1968	2256/1477-1483	12/30/1968	12/26/1968
54	William Koart, T10818, Open Space	Annexation	12/30/1968				109	12/20/1968	1968-AD-21	1968-118	12/12/1968	2256/1484-1489	12/30/1968	12/26/1968
55	William Koart, T10915	Annexation	12/30/1968				110	12/9/1968	1968-AD-40	1968-121	12/12/1968	2256/1490-1496	12/30/1968	12/26/1968
56	William Koart, T10915, Open Space	Annexation	12/12/1968				111		1968-AD-39	1968-122	12/12/1968			
57	William Koart, T10953, Open Space	Annexation	4/1/1969				112	3/10/1969	1969-AD-03	1969-134	2/27/1969	2266/1166-1172	4/1/1969	3/21/1969
58	William Koart, T10953	Annexation	3/21/1969				113	3/10/1969	1969-AD-04	1969-140	2/27/1969	2266/1160-1165	4/1/1969	3/21/1969
59	Goleta Valley Dev. Co., T10699, #2	Annexation	8/13/1969				115	8/11/1969	1969-AD-27	1969-162	7/10/1969	2281/0774-0780	8/18/1969	8/13/1969
60	William Koart, T10955	Annexation	8/13/1969				116	8/11/1969	1969-AD-20	1969-165	7/10/1969	2281/0767-0773	8/18/1969	8/13/1969
61	William Koart, T10955, Open Space	Annexation	8/13/1969				117	8/11/1969	1969-AD-21	1969-166	7/10/1969	2281/0781-0786	8/18/1969	8/13/1969
62	William Koart, Tract 10955, #2	Annexation	8/28/1970				119	7/13/1970	1970-AD-03	1970-204	6/25/1970	2319/0078-0084	8/28/1970	8/20/1970
63	Goleta Valley Dev. Co., T10699, #3	Annexation	10/26/1970				120	10/12/1970	1970-AD-23	1970-215	9/24/1970	2326/0630-0636	11/6/1970	10/26/1970
64	Midtown Development Co., T11174	Annexation	5/25/1971				121	4/13/1971	1971-AD-02	1971-229	2/25/1971	2348/0976-0983	5/25/1971	5/19/1971
65	Tract 11044	Annexation	11/21/1972				126	11/13/1972	1972-AD-47	1972-316	10/26/1972	2431/1330-1336	11/21/1972	11/17/1972
66	Tract 11470	Annexation	11/21/1972				127	11/13/1972	1972-AD-46	1972-317	10/26/1972	2431/1324-1329	11/21/1972	11/17/1972
67	Hope Ranch Park (Res. 122)	Annexation	12/26/1972				129	12/21/1972	1972-AD-45	1972-314	10/26/1972	2436/0864-0896	12/26/1972	12/22/1972

InternalNo	Title	Type	Effective	County_Res	County_DT	Dist_Res	Dist_Date	LAFCO_No	LAFCO_Res	LAFCO_DT	Instrument	Recorded	State_DT
68	Rancho Embarcadero Annex. (Res. 134)	Annexation	8/23/1973			136	8/13/1973	1973-AD-10	1973-345	6/26/1973	2478/0576-0583	8/23/1973	8/20/1973
69	San Antonio Creek Area Annex. (Res. 135)	Annexation	8/23/1973			137	8/13/1973	1973-AD-13	1973-346	6/26/1973	2478/0584-0592	8/23/1973	8/20/1973
70	Santa Barbara Airport	Annexation	12/5/1974			140	1/13/1975	1974-AD-08	1974-387	12/5/1974			
71	Daniels/Cavaletto	Annexation	11/29/1979			147	10/8/1979	1979-AD-13	1979-530	6/28/1979	1979-0056148	11/29/1979	1/2/1980
72	San Antonio Creeek Road Area #2 Annex.	Annexation	10/28/1981			150	10/12/1981	1981-AD-02	1981-592	9/3/1981	1981-0044050	10/28/1981	12/17/1981
73	Morin Annex.	Annexation	9/30/1983			155	7/11/1983	1982-AD-18	1983-641	5/26/1983	1983-0052626	9/30/1983	10/14/1983
74	APN 59-010-09, Shadow Hills Reorg.	Annexation	6/2/1987					1987-R-02	1987-750	4/23/1987	1987-0041085	6/2/1987	
75	Mountain View Ranch Annex.	Annexation	12/10/1998					1997-11	1997-11	10/30/1997	1998-0096421	12/10/1998	
76	Dos Pueblos Golf Links Reorgan.	Annexation	8/11/2008					1998-11	1998-11	9/2/1998	2008-0047472	8/11/2008	
77	Santa Barbara Coastal Vector Control District	Renaming	3/17/1998	98-82	3/17/1998	98-01					1998-0023136	8/4/1998	
78	Vector Control Dist. Reorg.: Dissolution of the Carpinteria Mosquito Abatement District / Annex. to the Santa Barbara Coastal Vector Control District	Annexation	2/16/1999	98-498	12/15/1998			1998-12	1998-12	11/5/1998	1999-0012142	2/16/1999	4/9/1999
79	Countywide Unincorporated Annex.	Annexation	6/12/2002					2001-11	2001-11	11/8/2001	2002-0057241	6/12/2002	
80	City of Santa Barbara Annex.	Annexation	6/11/2004					2003-15	2003-15	12/4/2003	2004-0062580	6/11/2004	
81	Hudgens Reorg.	Detachment	9/2/2005					2005-11	2005-11	9/1/2005	2005-0086081	9/2/2005	
82	Mosquito & Vector Management District of Santa Barbara County	Renaming	2/9/2006			06-01	2/9/2006			4/6/2006			
83	Burton Ranch Reorg.	Detachment	5/31/2007					2006-05	2006-05	5/4/2006	2007-0040552	5/31/2007	
84	Wastewater Treatment Plant Reorg.	Detachment	10/5/2007					2007-08	2007-08	9/6/2007	2007-0071432	10/5/2007	
85	Gowing Reorg.	Detachment	11/13/2007					2007-10	2007-10	9/6/2007	2007-0078906	11/13/2007	
86	Quail Run Reorg.	Detachment	1/28/2008					2007-11	2007-11	9/6/2007	2008-0004886	1/28/2008	
87	Enos Ranchos Reorg.	Detachment	8/7/2008					2008-04	2008-04	7/3/2008	2008-0046995	8/7/2008	
88	Summit View Homes Reorg.	Detachment	2/24/2016					2014-01	2016-01	1/17/2016	2016-0008389	2/24/2016	
	Sphere of Influence		11/4/2010 amended 2/24/2016							11/4/2010			

RESOLUTION OF THE SANTA BARBARA LOCAL AGENCY FORMATION  
COMMISSION MAKING WRITTEN DETERMINATIONS AND CEQA FINDINGS AND  
REAFFIRMING THE SPHERE OF INFLUENCE FOR THE  
MONTECITO FIRE PROTECTION DISTRICT

WHEREAS, a Sphere of Influence is defined as a plan for the probable physical boundaries and service area of a city or special district as adopted by the Commission, and

WHEREAS, the Commission is required to review and update, as necessary, adopted spheres of influence not less than every five years, and

WHEREAS, the Commission is directed to conduct a review of municipal services not later than the time it considers an action to establish or update a sphere of influence, and

WHEREAS, the Commission conducted a municipal service review and adopted a Sphere of Influence for the Montecito Fire Protection District on November 3, 2005, and reaffirmed the District's Sphere of Influence on November 4, 2010, and

WHEREAS, in the manner required by law, has given notice of the public hearing by the Commission to review and update the sphere of influence, and

WHEREAS, the Commission has heard, discussed and considered all relevant evidence, including but not limited to, the Executive Officer report, and environmental documents, applicable general and specific, plans and all testimony, correspondence and exhibits received during the public hearing, all of which are included hearing by reference,

NOW THEREFORE, IT IS RESOLVED DETERMINED AND ORDED as follows:

1. The project before the Commission is an update of the sphere of influence the Montecito Fire Protection District.
2. The Commission finds this update to be exempt from CEQA because no change of the sphere of influence is being adopted.
3. The sphere of influence is hereby updated and no change is made to the map attached as Exhibit A
4. This resolution was adopted on January 4, 2018 and is effective on the date signed by the Chair.

AYES:

NOES:

ABSTAINS:

Dated: \_\_\_\_\_

\_\_\_\_\_  
Chair  
Santa Barbara Local Agency  
Formation Commission

ATTEST

\_\_\_\_\_  
Jacquelyne Alexander, Clerk  
Santa Barbara Local Agency Formation Commission

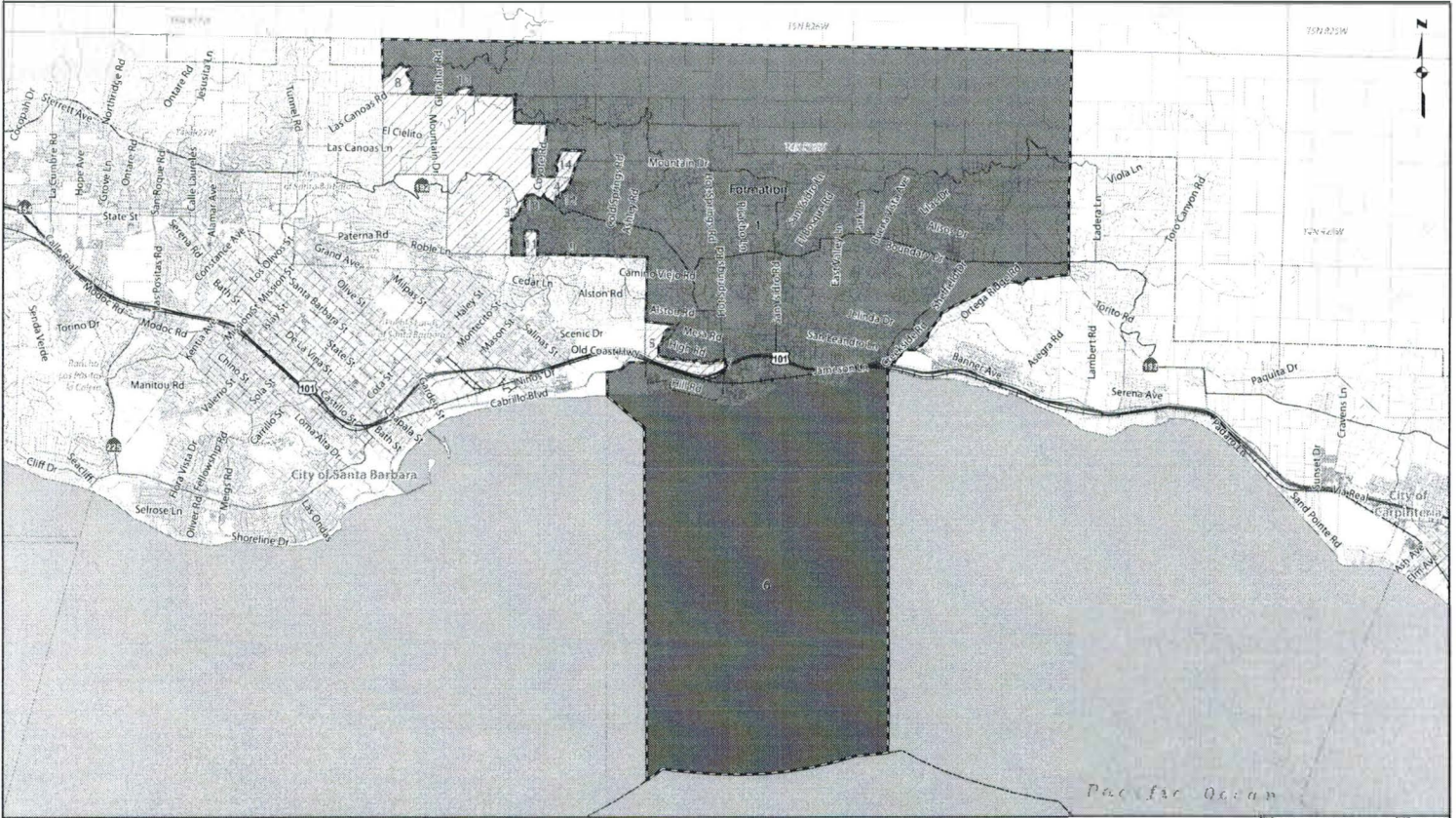

### Montecito Fire Protection District

Compiled by the Santa Barbara County Surveyor's Office on 12/11/2012. Last action: Westmont Reorganization 94-14, recorded 8/28/1995. Sphere updated with no changes on 11/4/2010. See boundary activity table at <http://www.countyofsb.org/pwd/pwsurveyor.aspx?id=23260>

NOTICE OF DISCLAIMER: This data is for reference only. Although every effort has been made to ensure the accuracy of information, errors and conditions originating from physical sources used to develop the database may be reflected in this data. Santa Barbara County shall not be liable for any errors, omissions, or damages that result from inappropriate use of this document. No level of accuracy is claimed for the boundary lines shown hereon and lines should not be used to obtain coordinate values, bearings or distances.



- Legend**
- Freeways
  - Highways
  - Roads
  - Railroads

- City Boundary
- County Boundary
- ▨ Los Padres National Forest
- Sections
- Ranchos and Townships

- ▭ Sphere of Influence
- ▭ Formation
- ▭ Annexation
- ▨ Detachment



## Montecito Fire Protection District Boundary Activity

See map at <http://www.countyofsb.org/pwd/pwsurveyor.aspx?id=23260>

InternalNo	Title	Type	Effective	County Res	County Dat	City Res	City Date	LAFCO Res	LAFCO Date	Instrument	Recorded
0	Montecito Fire Protection District Formation	Formation	5/7/1917	Minutes451	5/7/1917						
1	Reorganization	Formation	3/2/1953	12016	3/2/1953						
2	Establishment of Boundaries	Detachment	11/16/1953	12838	11/16/1953	1066					
3	Sycamore Canyon	Detachment	5/21/1962	22774	5/21/1962	2721					
4	Montecito Circle	Detachment	5/21/1962	22774	5/21/1962	2752					
5	Montecito Strip (aka Old Coast Hwy)	Detachment	5/21/1962	22774	5/21/1962	2765					
6	Tide & Submerged Lands	Annexation	7/29/1963	23348	7/29/1963						
7	Lina Robillard	Detachment	12/10/1963			5682	12/10/1963				
8	St. Mary's Seminary	Detachment	5/28/1968			6654	5/28/1968				
9	Alexander	Detachment	12/6/1969			6960	12/6/1969				
10	Eucalyptus Knolls #2 (aka Williams Property)	Detachment	3/15/1979			1979-016		1978-511		1979-011541	3/15/1979
11	Thompson Property (Via Alicia)	Detachment	10/16/1980			1980-055		1997-481		1980-042161	10/16/1980
12	Mark Edwards	Detachment	7/22/1982			1980-573		1981-594		1982-030244	7/22/1982
13	Sanchez	Detachment	1/11/1985			1984-191		1984-671		1985-001805	1/11/1985
14	Westmont Reorganization	Detachment	8/28/1995			1995-014		1994-14		1995-048109	8/28/1995
	Montecito Fire Sphere of Influence	SOI	11/4/2010								11/4/2010

RESOLUTION OF THE SANTA BARBARA LOCAL AGENCY FORMATION  
COMMISSION MAKING WRITTEN DETERMINATIONS AND CEQA FINDINGS AND  
REAFFIRMING THE SPHERE OF INFLUENCE FOR THE  
MONTECITO WATER DISTRICT

WHEREAS, a Sphere of Influence is defined as a plan for the probable physical boundaries and service area of a city or special district as adopted by the Commission, and

WHEREAS, the Commission is required to review and update, as necessary, adopted spheres of influence not less than every five years, and

WHEREAS, the Commission is directed to conduct a review of municipal services not later than the time it considers an action to establish or update a sphere of influence, and

WHEREAS, the Commission conducted a municipal service review and adopted a Sphere of Influence for the Montecito Water District on November 3, 2005, and reaffirmed the District's Sphere of Influence on March 1, 2012, and

WHEREAS, in the manner required by law, has given notice of the public hearing by the Commission to review and update the sphere of influence, and

WHEREAS, the Commission has heard, discussed and considered all relevant evidence, including but not limited to, the Executive Officer report, and environmental documents, applicable general and specific, plans and all testimony, correspondence and exhibits received during the public hearing, all of which are included hearing by reference,

NOW THEREFORE, IT IS RESOLVED DETERMINED AND ORDED as follows:

1. The project before the Commission is an update of the sphere of influence the Montecito Water District.
2. The Commission finds this update to be exempt from CEQA because no change of the sphere of influence is being adopted.
3. The sphere of influence is hereby updated and no change is made to the map attached as Exhibit A
4. This resolution was adopted on January 4, 2018 and is effective on the date signed by the Chair.



AYES:

NOES:

ABSTAINS:

Dated: \_\_\_\_\_

\_\_\_\_\_  
Chair  
Santa Barbara Local Agency  
Formation Commission

ATTEST

\_\_\_\_\_  
Jacquelyne Alexander, Clerk  
Santa Barbara Local Agency Formation Commission

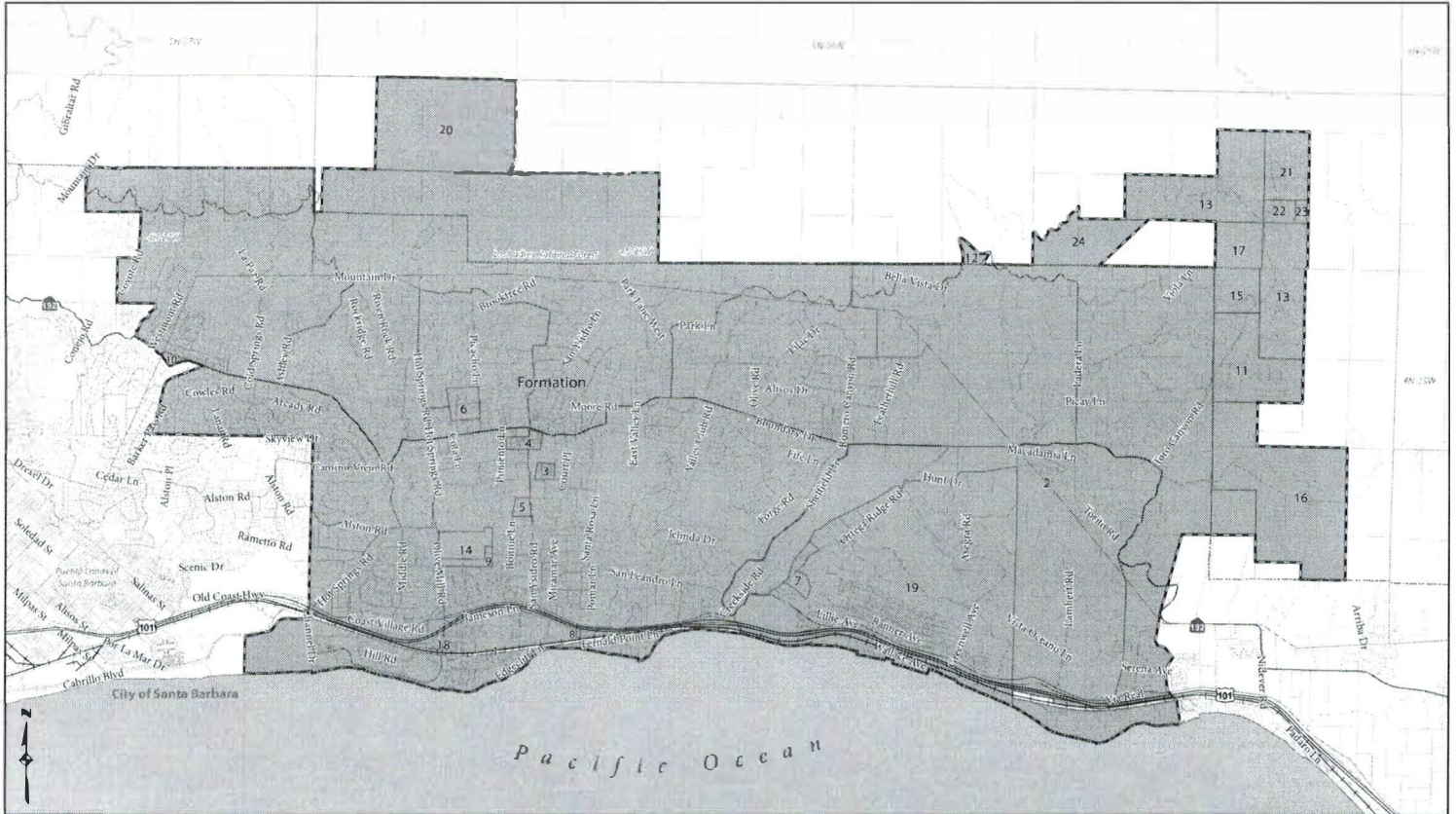

### Montecito Water District

Compiled by the Office of the County Surveyor in October of 2014.  
 Formed by resolution of the County Board of Supervisors, BOS Minute Book T, Pages 287-293, 11/7/1921.  
 Sphere 3/1/2012. Last Action: 24, Bella Vista Annexation, AFCD 10 01, 5/6/2010.  
 See Boundary activity table at <http://www.countyofsb.org/pwd/pwsurveyor.aspx?id=23260>

NOTICE OF DISCLAIMER: This data is for reference only. Although every effort has been made to ensure the accuracy of information, errors and omissions originating from physical sources used to develop the drawings may be reflected in this data. Santa Barbara County shall not be liable for any errors, omissions, or damages that result from inappropriate use of this document. No level of accuracy is claimed for the boundary lines shown herein and they should not be used to obtain coordinate values, bearings, or distances.

GRAPHIC SCALE



#### Legend

- Freeways
- Highways
- Roads
- Railroads
- ▭ Parcels
- ▭ Sections
- ▭ Ranchos and Townships
- ▭ Los Padres National Forest
- ▭ City Boundaries
- Sphere of Influence
- Formation
- Annexation
- ▭ Detachment



## Montecito Water District Boundary Activity

See map at <http://www.countyofsb.org/pwd/pwsurveyor.aspx?id=23260>

Note: Only the portion of the SPRR Detachment (1) not annexed by the Berenzer Annexation (18) is depicted

InternalNo	Title	Type	Effective	County Res	County DT	LAFCO Res	Dist Ord	Dist DT	Instrument	Recorded
0	Montecito Water District Formation	Formation	11/7/1921	Minute T/287	11/7/1921					
1	SPRR Detachment	Detachment	6/12/1922					6/12/1922		
2	Ordinance 6	Annexation	12/29/1925				6	12/29/1925		
3	Langley Hill	Annexation	12/29/1925				7	12/29/1925		
4	Ordinance No. 8	Annexation	12/29/1925				8	12/29/1925		
5	Ordinance No. 9	Annexation	12/29/1925				9	12/29/1925		
6	Barnes & Barnes	Annexation	3/27/1934				15	3/27/1934		
7	Ortega Hill	Annexation	3/27/1934				16	3/27/1934		
8	King	Annexation	1/19/1948	7768	1/19/1948					
9	Ordinance No. 20	Annexation	3/1/1948							
10	Ordinance No. 23	Annexation	5/19/1948							
11	Ordinance No. 37	Annexation	4/15/1959	19850	4/15/1959					
12	Ordinance No. 38	Annexation	4/15/1959	19850	4/15/1959					
13	Stegall	Annexation	12/2/1969	1108 A		1968-181			2291/1434-1444	12/2/1969
14	Casa Dorinda	Annexation	7/23/1974	1362-A		1973-341			1974-0027146	7/23/1974
15	Slovak Bondi	Annexation	8/16/1994			1994-09			1994-0064238	8/16/1994
16	Miller Reorganization	Annexation	8/17/1994			1994-10			1994-0064734	8/17/1994
17	Knoll	Annexation	8/26/1994			1994-11			1994-0066591	8/26/1994
18	Berenzer	Annexation	12/12/1994			1994-13			1994-0089380	12/12/1994
19	Summerland Water Reorg.	Annexation	12/6/1995			1994-21			1995-0068098	12/6/1995
20	McCaslin	Annexation	7/8/1996			1995-13			1996-0041210	7/8/1996
21	Vista	Annexation	11/18/1997			1996-16			1997-0069733	11/18/1997
22	Gostovich	Annexation	7/27/2000			2000-04			2000-0045765	7/27/2000
23	Dishion	Annexation	10/11/2001			2001-10			2001-0087500	10/11/2001
24	Bella Vista Annexation	Annexation	5/6/2010			2010-01			2010-0043982	8/16/2010
	Montecito Water District SOI	Sphere	3/1/2012							