

# L A F C O M E M O R A N D U M

---

**SANTA BARBARA LOCAL AGENCY FORMATION COMMISSION**  
105 East Anapamu Street ♦ Santa Barbara CA 93101 ♦ (805) 568-3391 ♦ Fax (805) 568-2249

---

December 12, 2019 (Agenda)

TO: Each Member of the Commission

FROM: Paul Hood *PLH*  
Executive Officer

SUBJECT: **Report on Janin Acres/Quail Valley Sphere of Influence Revision**

*This is an Informational Report. No Action is Necessary*

## Background

Over the past several months, the Commission has processed several annexations and out-of-agency-service agreements for the Janin Acres area. The area is within the sphere of influence of the City of Solvang although wastewater collection services have been provided by the Santa Ynez Community Services District (CSD). The reason for the annexations and out-of-agency-service agreements is because of failing septic tanks to existing or proposed residential units. The Santa Ynez CSD has a sewage collection line in the adjacent Highway 246.

On August 12, 2019, your staff met with representatives of the City of Solvang, the Santa Ynez CSD, and County Environmental Health Services to discuss amending the City's Sphere of Influence (SOI) to include the Janin Acres area in the district's SOI. The eventual goal would be to annex the entire area to the Santa Ynez CSD.

Additional meetings are proposed to further discuss this matter.

## EXHIBIT

Exhibit A Solvang City Limits and Sphere of Influence  
Exhibit B Santa Ynez CSD Boundaries and Sphere of Influence

Please contact the LAFCO office if you have any questions.

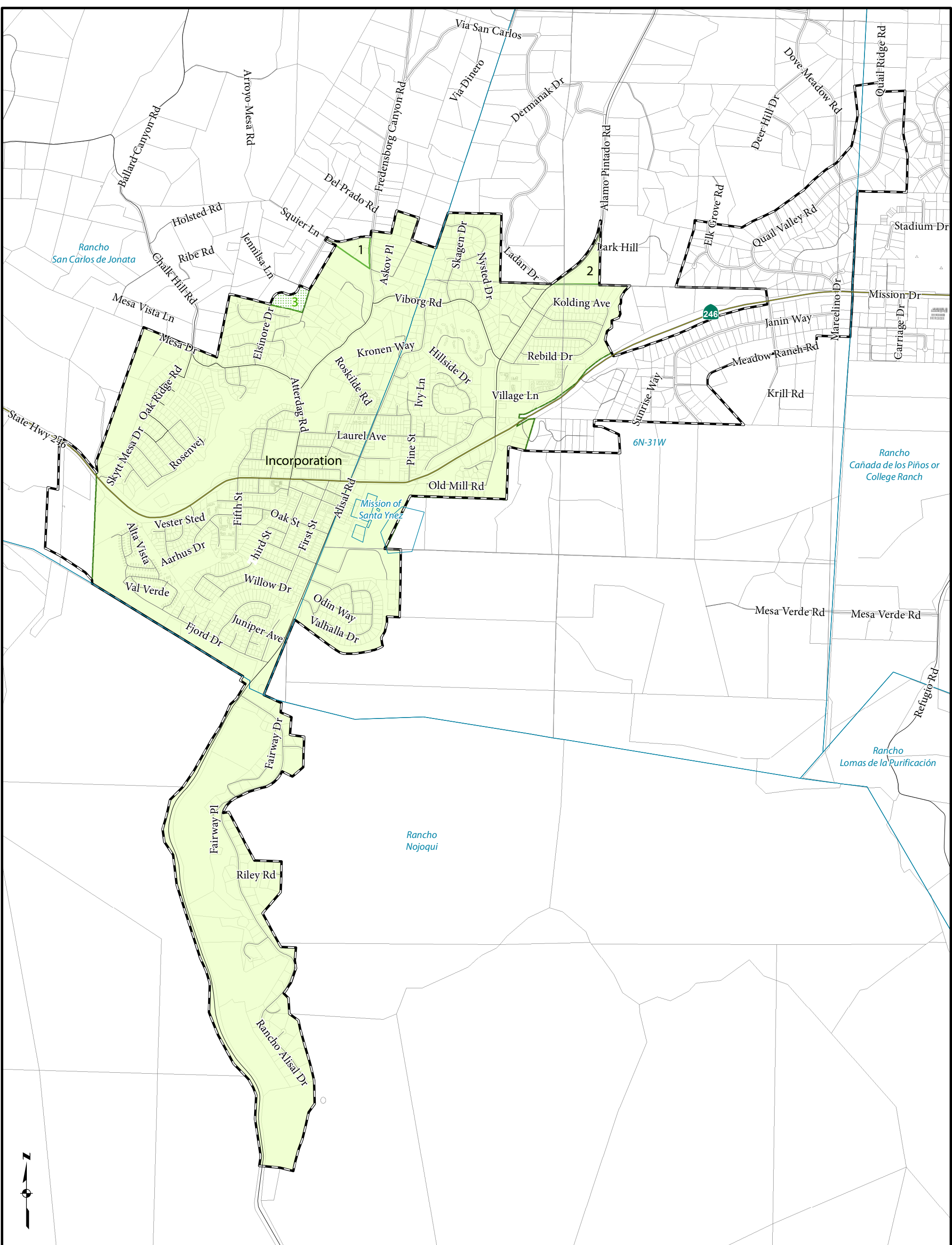

# City of Solvang

Compiled by the Office of the County Surveyor in July of 2016.  
 Incorporated 12/17/1984, by LAFCO Case 82-R-1,  
 Recorded as 1984-0066853, Official Records.  
 Last Action: 3, Seltzer Modification,  
 Out-Of-Agency-Agreement LAFCO 05-14, 9/1/2005.  
 Sphere: 11/4/2010. See boundary activity table at  
<http://www.countyofsb.org/pwd/pwsurveyor.aspx?id=5118>

NOTICE OF DISCLAIMER: This data is for reference only. Although every effort has been made to ensure the accuracy of information, errors and conditions originating from physical sources used to develop the database may be reflected in this data. Santa Barbara County shall not be liable for any errors, omissions, or damages that result from inappropriate use of this document. No level of accuracy is claimed for the boundary lines shown hereon and lines should not be used to obtain coordinate values, bearings or distances.

## Legend

- Freeways
- Highways
- Roads
- Railroads
- Parcels
- Sections
- Ranchos and Townships
- City Boundary
- Sphere of Influence
- Out-of-Agency
- Annexation
- Incorporation
- Detachment

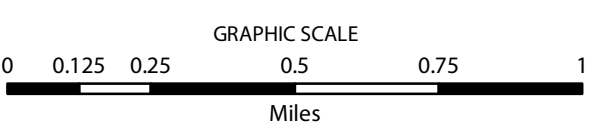



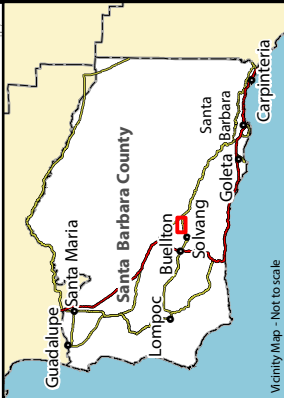
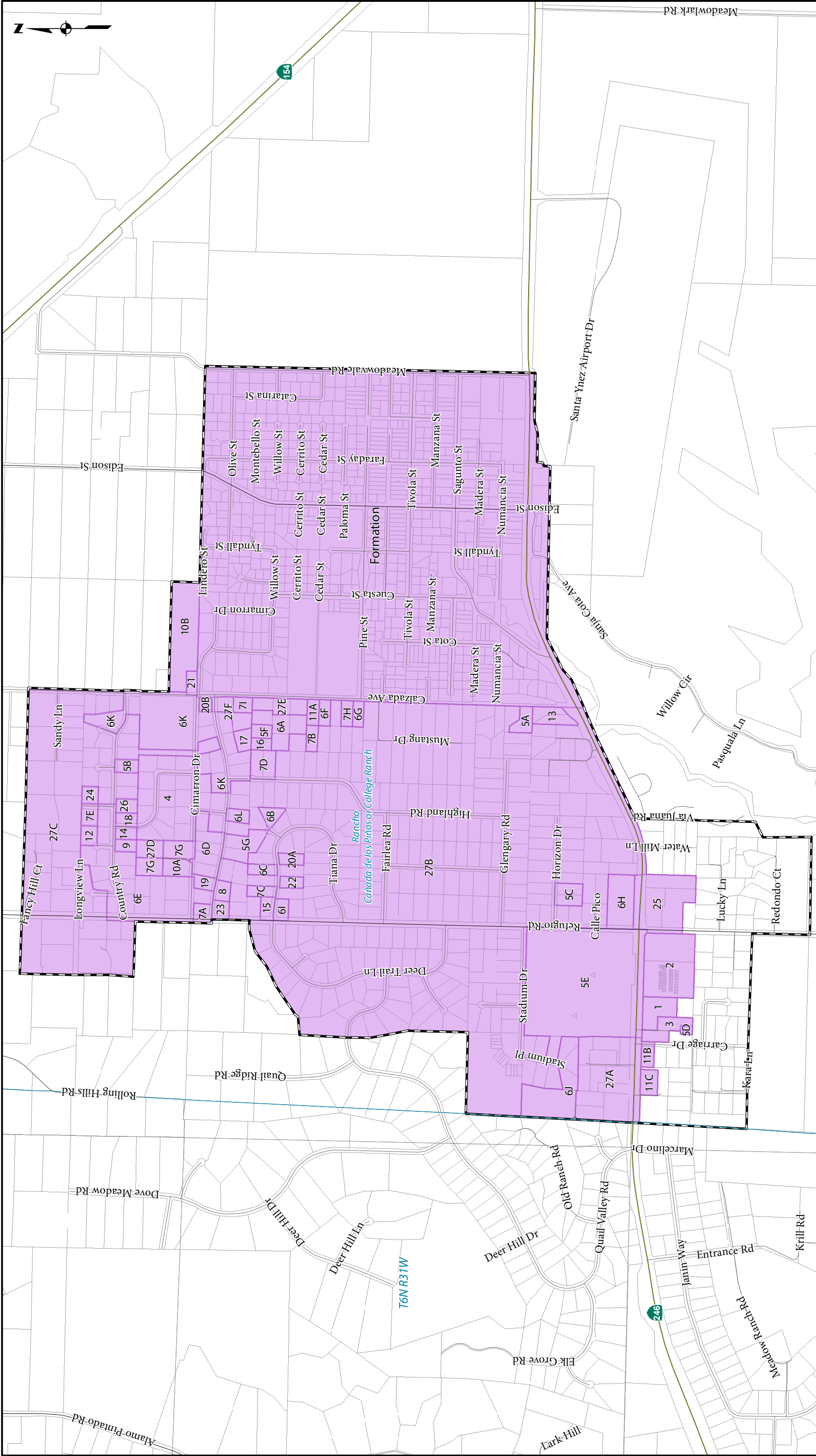

- Legend**
- Ranchos and Townships
  - Freeways
  - Highways
  - Roads
  - Parcels
  - Sections
  - Sphere of Influence
  - Formation
  - Annexation
  - Detachment

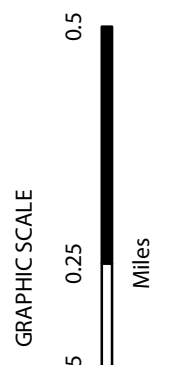

# Santa Ynez Community Services District

Compiled by the Office of the County Surveyor on 06/20/2018. Formed by Board of Supervisors Resolution 71-773, Recorded 11/29/1971, Inst. 2374/OR/48. Last Action: 27, LAFCO 16-02, West Santa Ynez Annex., 03/29/2017. Sphere: 04/05/2012 See boundary activity table at <http://www.countyofsb.org/pwd/pwsurveyor.aspx?id=23260>

NOTICE OF DISCLAIMER: This data is for reference only. Although every effort has been made to ensure the accuracy of information, errors and conditions originating from physical sources used to develop the database may be reflected in this data. Santa Barbara County shall not be liable for any errors, omissions, or damages that result from inappropriate use of this document. No level of accuracy is claimed for the boundary lines shown hereon and lines should not be used to obtain coordinate values, bearings or distances.

