

Santa Barbara LAFCO

Santa Claus Lane Restroom
Annexation to the Carpinteria Sanitary District

January 6, 2022

Background

- Applicant: District, by Resolution
- Location: Santa Barbara County ROW, on Santa Claus Lane total 0.0465 acres
- Purpose: Annex into the Carpinteria Sanitary District to provide sanitary sewer services to restroom facility
- Sphere of Influence: The proposal area is outside of the District's Sphere of Influence (Updated in 2021)

Vicinity Map

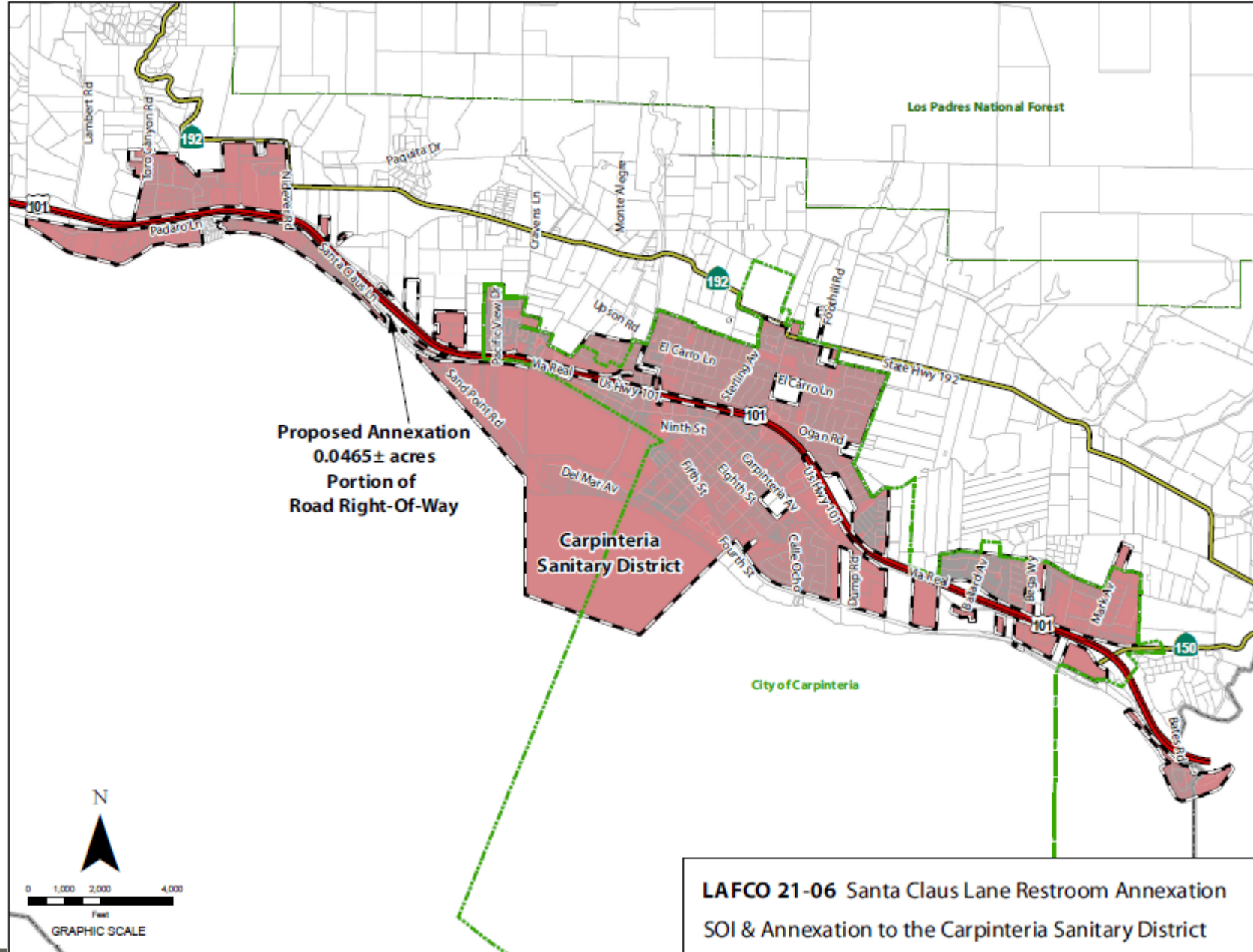

Annexation Map

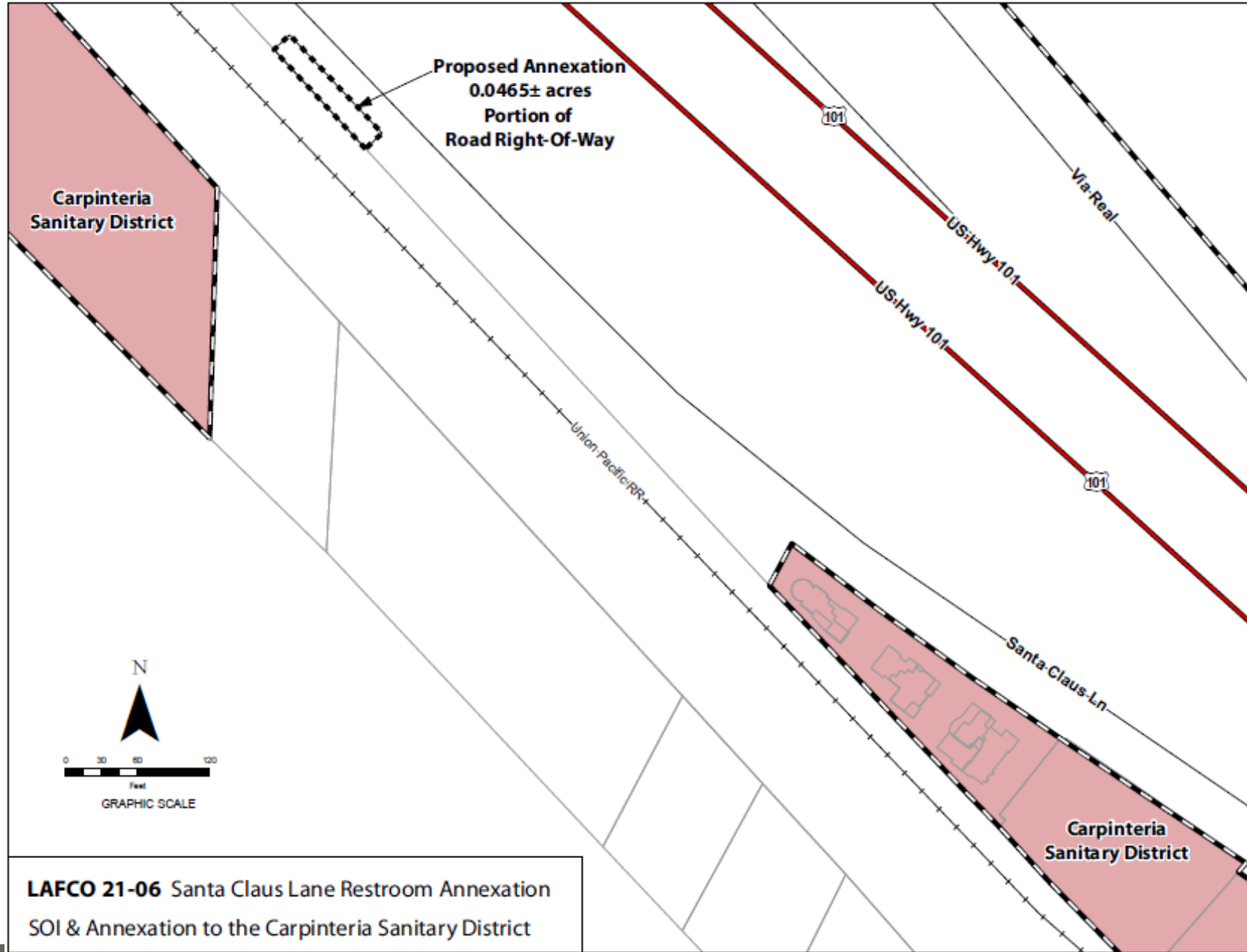

Land Use, Planning and Zoning

LAFCO

Santa Barbara Local Agency
Formation Commission

- The land use is Transportation Corridor (TC)
- No changes in land use will be facilitated by the proposed boundary change
- Land use designations and zoning are Transportation Corridor (TC) in the County part of the Toro Canyon Plan area

Change of Organization Item
No 1

Plan for Services

- The District's Plan for Services outline the adequate services, facilities, and improvements
- The Plan for Services address the provision of governmental services and financing of improvements
- Plan for Services found in Attachment F
- Existing sewer line is west on Santa Claus Lane at approx. 640 lineal feet

Environmental Determination

LAFCO

Santa Barbara Local Agency
Formation Commission

- The proposal considered as part of the Mitigated Negative Declaration for the Santa Claus Lane Beach Access and Streetscape Improvement Project
- Commission to find that it has considered the Final Mitigated Negative Declaration prepared by the County of Santa Barbara pursuant to CEQA

Change of Organization Item
No 1

District and Landowner Consent

- Parcel is “uninhabited” – less than 12 voters (GC sec. 56079.5)
- The District has consented to waving conducting authority proceedings
- The Property owners have also consented to the annexation
- Therefore, the annexation can proceed without notice, hearing and election

Conclusion

- The site is located in an area that allows the District to best provide services in the future
- The proposed annexation represents a reasonable and logical extension of district services

Recommendation

OPTION 1 – APPROVE the proposal and resolution as follows:

- Find that the Commission has considered the Final Mitigated Negative Declaration prepared by the County of Santa Barbara as Leas Agency under the California Environmental Quality Act (CEQA), Public Resources Code Section 21000 et seq., for the Santa Claus Lane Beach Access and Streetscape Improvement Project.
- Amend the Spheres of Influence of the annexing agency to include approximately 2,026 square feet (0.0465 acres) located within Santa Barbara County ROW;
- Approve the proposal, to be known as Santa Claus lane Restroom SOI and Annexation to the Carpinteria Sanitary District;
- Condition approval upon the annexed territory being liable for any existing indebtedness and authorized taxes, charges, fees and assessments of the Carpinteria Sanitary District;
- Find the subject territory is uninhabited; all affected landowners have given written consent and the annexing agency has given written consent to the waiver of conducting authority proceedings; and.
- Waive the conducting authority proceedings and direct the staff to complete the proceeding.